

Xtralite

ROOFLIGHTS

XLS Panel Standard Details

XTRALITE (ROOFLIGHTS) LTD.
SPENCER ROAD,
BLYTH INDUSTRIAL ESTATE,
BLYTH,
NORTHUMBERLAND.
NE24 5TF

E-mail Drawings@xtralite.co.uk

Tel No. (01670) 354157

Fax No. (01670) 364875

International Tel No. (0044) 1670 354157

International fax No. (0044) 1670 364875

Reference number		Description
1	A	XLS panel fixing (exploded view)
2	B	Interlocked XLS panels
3	A	Panel insertion
4	A	Section through typical xls panel
5	A	XLS breaker panel detail
6	A	Components list
7	B	Typical XLS panel head detail
8	B	Typical XLS panel head detail
9	B	Typical XLS panel head detail
11	B	Typical XLS panel head detail
12	A	Typical XLS panel eaves detail
13	A	Typical XLS panel eaves detail preferred
14	B	Typical XLS panel wall abutment detail
15	A	Typical XLS small gable end detail
16	A	Typical XLS panel side wall detail
17	B	Typical XLS panel wall abutment detail
18	B	Typical wall abutment detail
19	C	Typical XLS panel ridge detail
20	C	Typical XLS panel ridge detail
21	C	Typical XLS panel ridge detail
23	B	Glazing to existing timber frame
24	A	Typical detail for XLS panel overlap
25	B	Typical structural gutter detail
26	A	Typical curb flashings
27	A	XLS system end cap fixing
28	A	Survey guide single roof opening
29	A	XLS fixing instructions
30	A	XLS fixing instructions (breaker panel).



Xtralite
ROOFLIGHTS

XTRALITE (ROOFLIGHTS) LTD.
SPENCER ROAD,
BLYTH INDUSTRIAL ESTATE,
BLYTH,
NORTHUMBERLAND,
NE24 5TG
E-mail Drawings@xtralite.co.uk
Tel No. (01670) 354157
Fax No. (01670) 364875
International Tel No. (0044) 1670 354157
International fax No. (0044) 1670 364875

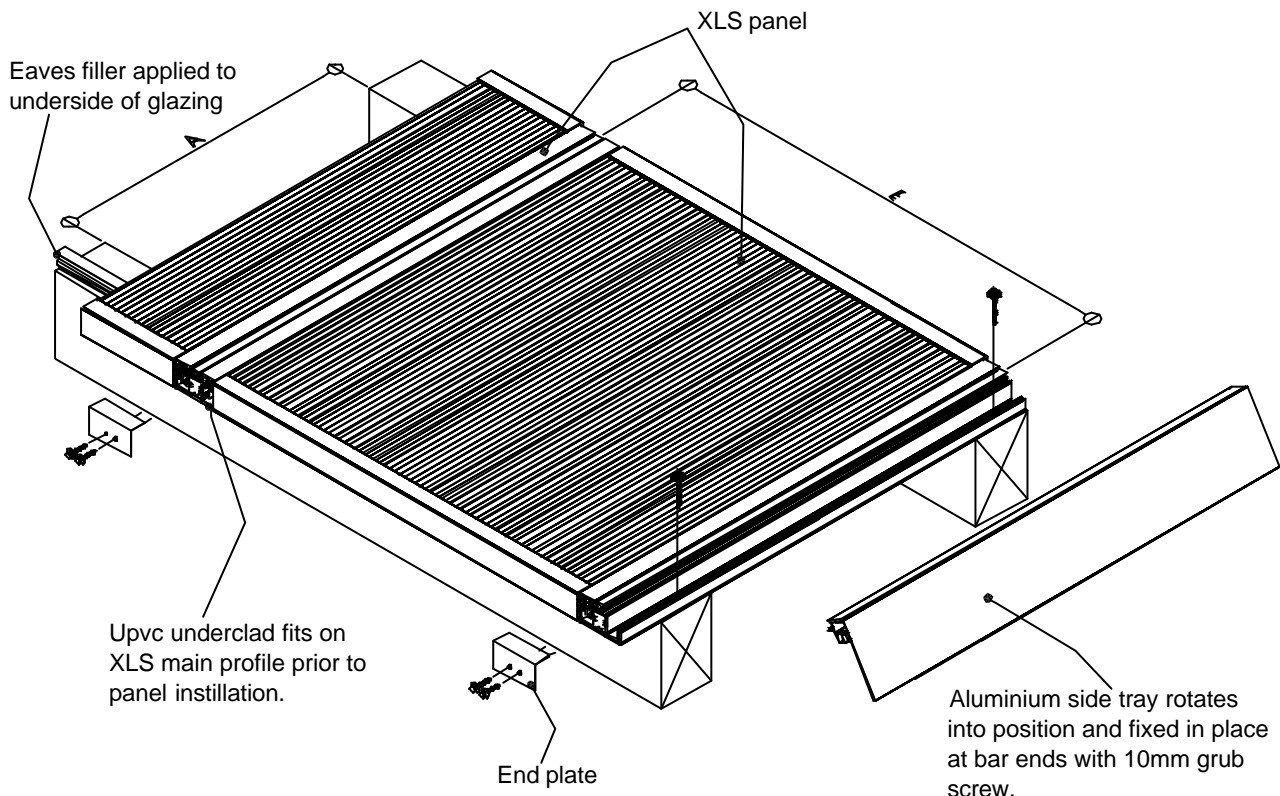

	Maximum span (A) (unsupported)	Maximum Panel width (B)
16mm Multiwall glazing sheet	3000mm	1000mm

XLS Panel Fixing

Ref No 01
Issue A



Xtralite
ROOFLIGHTS

XTRALITE (ROOFLIGHTS) LTD.
SPENCER ROAD,
BLYTH INDUSTRIAL ESTATE,
BLYTH,
NORTHUMBERLAND,
NE24 5TF
E-mail Drawings@xtralite.co.uk
Tel No. (01670) 354157
Fax No. (01670) 364875
International Tel No. (0044) 1670 354157
International fax No. (0044) 1670 364875

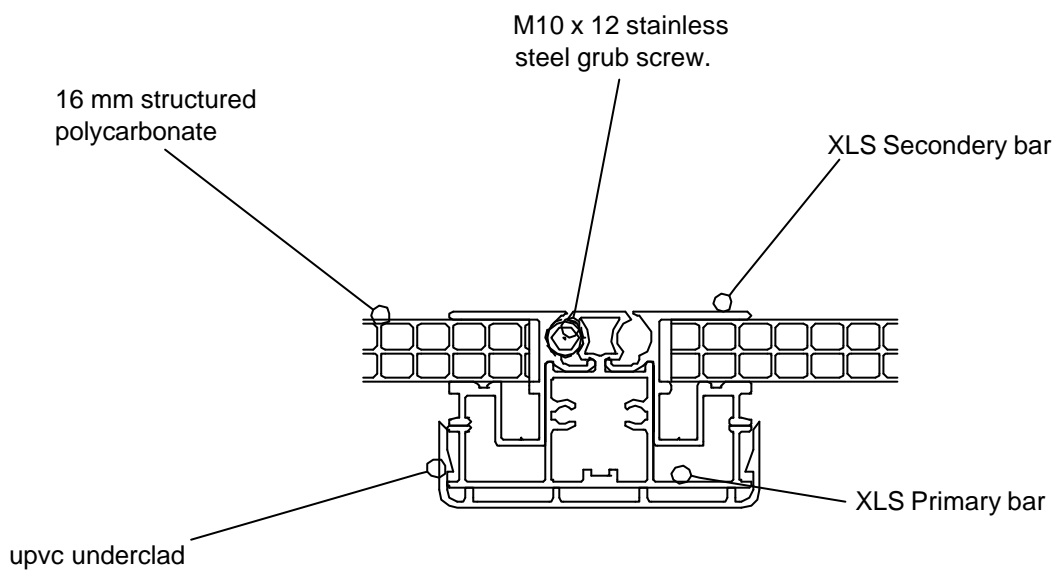

Interlocked XLS panels



Xtralite
ROOFLIGHTS

XTRALITE (ROOFLIGHTS) LTD.
SPENCER ROAD,
BLYTH INDUSTRIAL ESTATE,
BLYTH,
NORTHUMBERLAND,
NE24 5TF
E-mail Drawings@xtralite.co.uk
Tel No. (01670) 354157
Fax No. (01670) 364875
International Tel No. (0044) 1670 354157
International fax No. (0044) 1670 364875

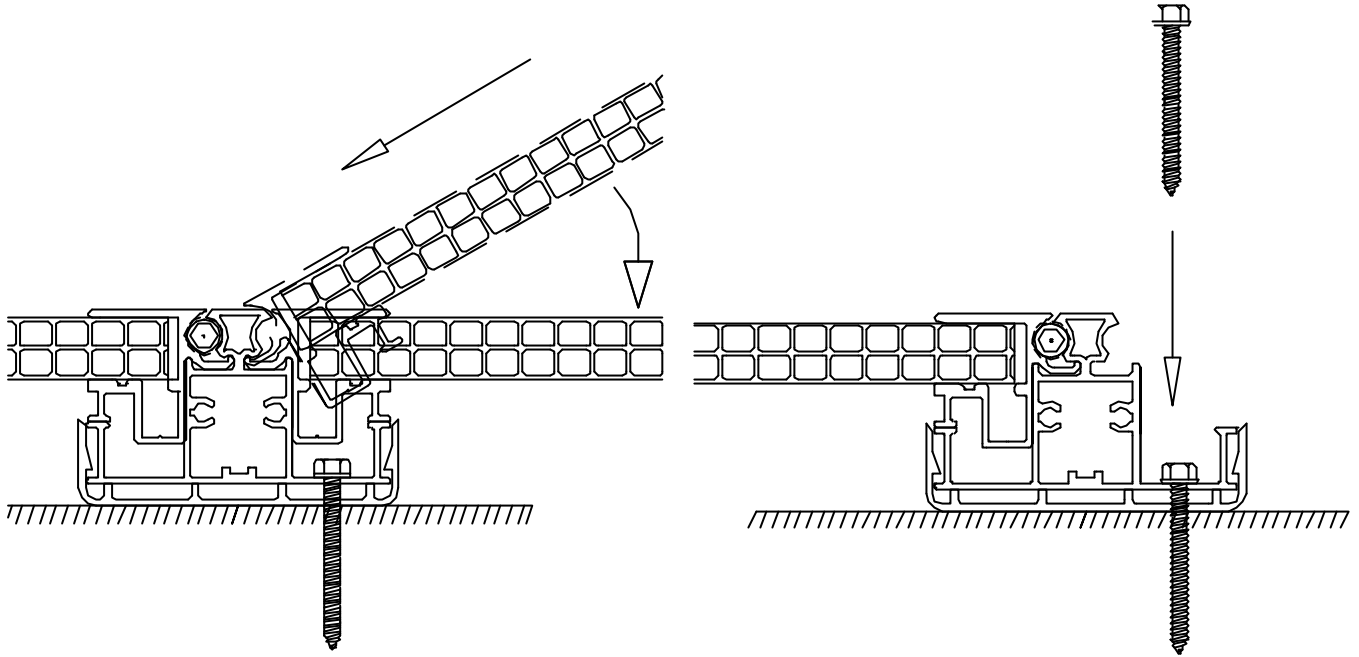

Method of panel insertion
and interlocking

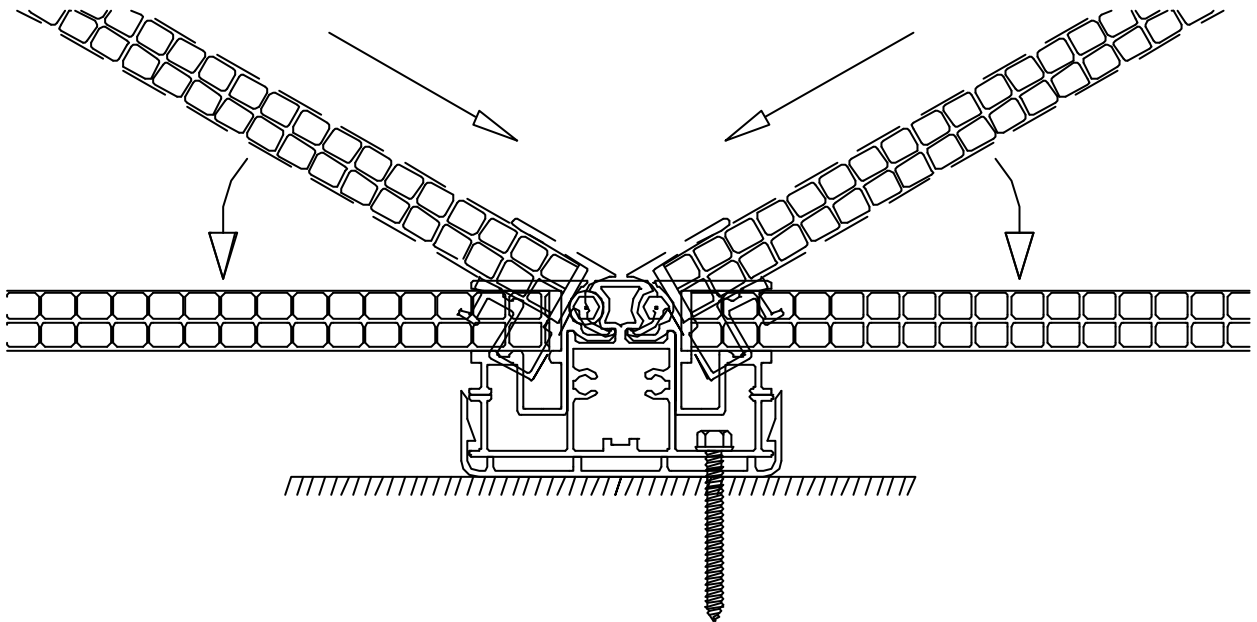

Panel insertion from
either side

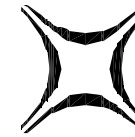

Xtralite
ROOFLIGHTS

XTRALITE (ROOFLIGHTS) LTD.
SPENCER ROAD,
BLYTH INDUSTRIAL ESTATE,
BLYTH,
NORTHUMBERLAND,
NE24 5TF
E-mail Drawings@xtralite.co.uk
Tel No. (01670) 354157
Fax No. (01670) 364875
International Tel No. (0044) 1670 354157
International fax No. (0044) 1670 364875

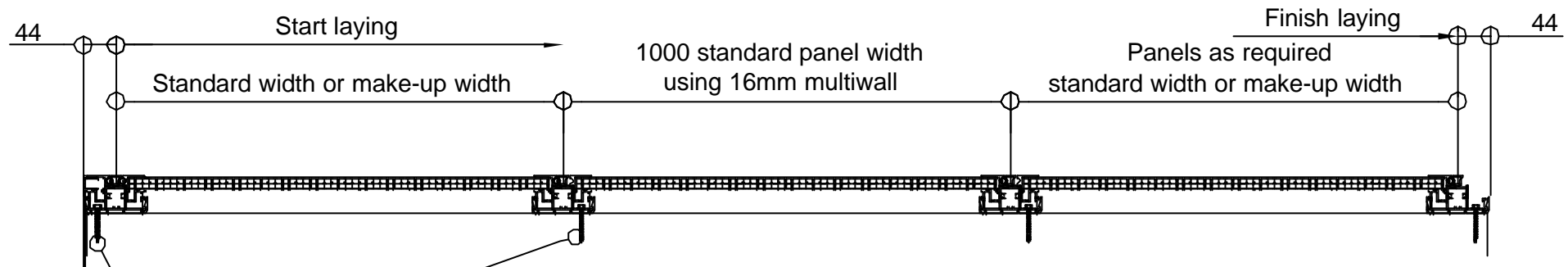

N.B. Screw fixed both sides of starter panel.

Section through typical XLS panels

Ref No 04
issue A

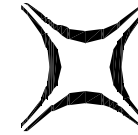

Xtralite
ROOFLIGHTS

XTRALITE (ROOFLIGHTS) LTD.
SPENCER ROAD,
BLYTH INDUSTRIAL ESTATE,
BLYTH,
NORTHUMBERLAND,
NE24 5TF
E-mail Drawings@xtralite.co.uk
Tel No. (01670) 354157
Fax No. (01670) 364875
International Tel No. (0044) 1670 354157
International fax No. (0044) 1670 364875

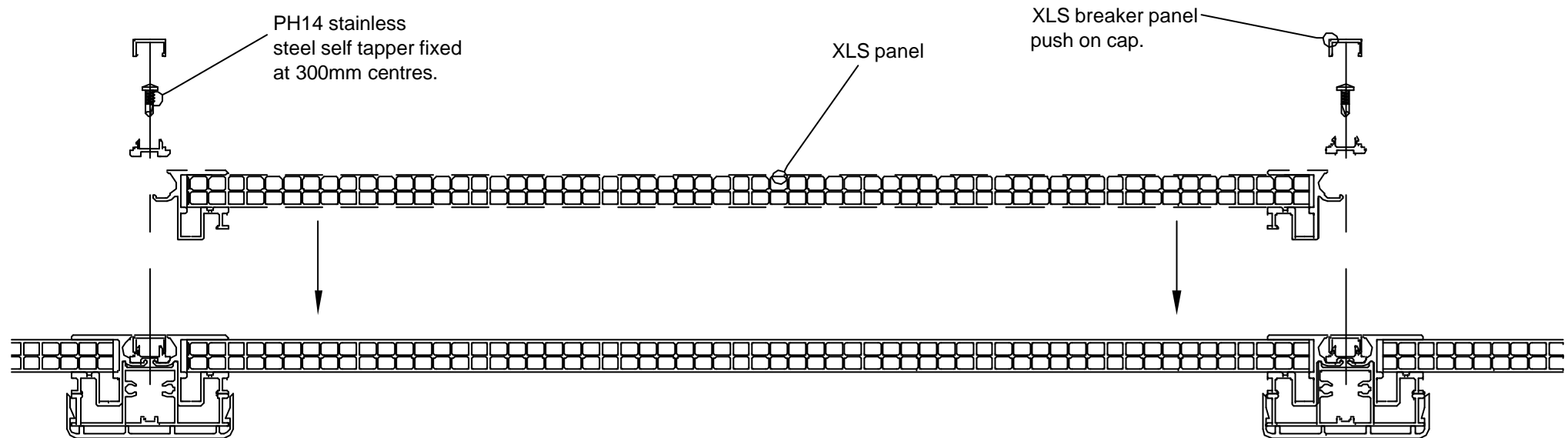

XLS breaker panel detail

Ref No 05
issue A



ITEM A
SELF ADHESIVE CO-EXTRUDED
DRAUGHT EXCLUDER.



Xtralite
ROOFLIGHTS

XTRALITE (ROOFLIGHTS) LTD.
SPENCER ROAD,
BLYTH INDUSTRIAL ESTATE,
BLYTH,
NORTHUMBERLAND,
NE24 5TF
E-mail Drawings@xtralite.co.uk
Tel No. (01670) 354157
Fax No. (01670) 364875
International Tel No. (0044) 1670 354157
International fax No. (0044) 1670 364875



ITEM B
XLS STARTER PANEL



ITEM C
45mm `C`
SCREW

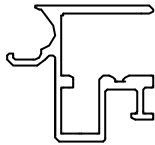

ITEM D
SIDE FLASHING
ADAPTOR



ITEM E
10mm GRUB
SCREW

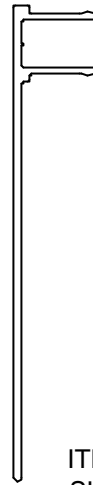

ITEM F
SIDE FLASHING



ITEM I
25mm `C`
SCREW



ITEM N
PRESSURE
CAP



ITEM M
PRESSURE
PLATE

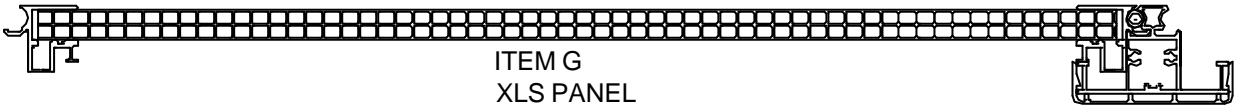

ITEM G
XLS PANEL

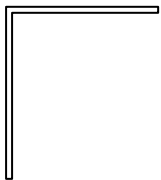

ITEM H
BAR END CLOSER.



ITEM J
2mm PRESSED
ALUMINIUM HEAD
FLASHING

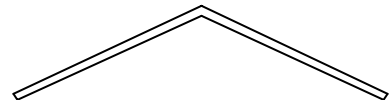

ITEM L
2mm PRESSED
ALUMINIUM RIDGE
FLASHING

ITEM J IS ONLY SUPPLIED WITH
MONOPITCH ROOFLIGHTS.
ITEM L IS ONLY SUPPLIED WITH
RIDGELIGHT ROOFLIGHTS.



Xtralite
ROOFLIGHTS

XTRALITE (ROOFLIGHTS) LTD.
SPENCER ROAD,
BLYTH INDUSTRIAL ESTATE,
BLYTH,
NORTHUMBERLAND,
NE24 5TF
E-mail Drawings@xtralite.co.uk
Tel No. (01670) 354157
Fax No. (01670) 364875
International Tel No. (0044) 1670 354157
International fax No. (0044) 1670 364875

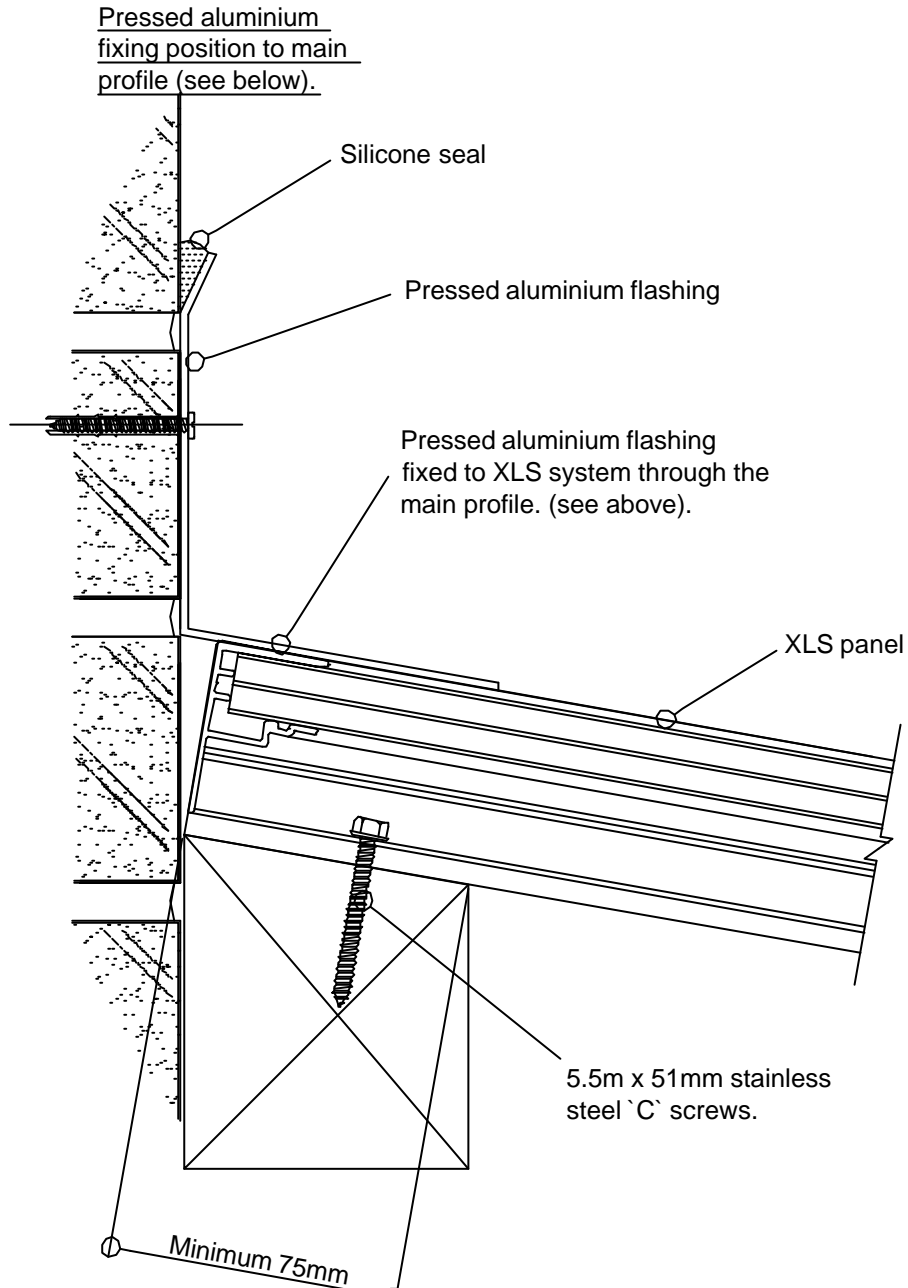
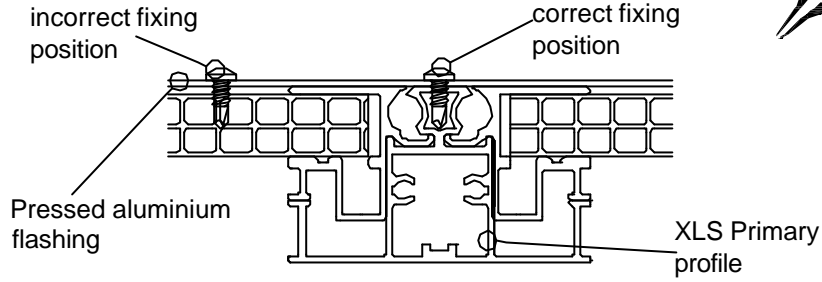

Typical XLS panel head detail
minimum pitch 10°
non preferred



Xtralite
ROOFLIGHTS

XTRALITE (ROOFLIGHTS) LTD.
SPENCER ROAD,
BLYTH INDUSTRIAL ESTATE,
BLYTH,
NORTHUMBERLAND,
NE24 5TF
E-mail Drawings@xtralite.co.uk
Tel No. (01670) 354157
Fax No. (01670) 364875
International Tel No. (0044) 1670 354157
International fax No. (0044) 1670 364875

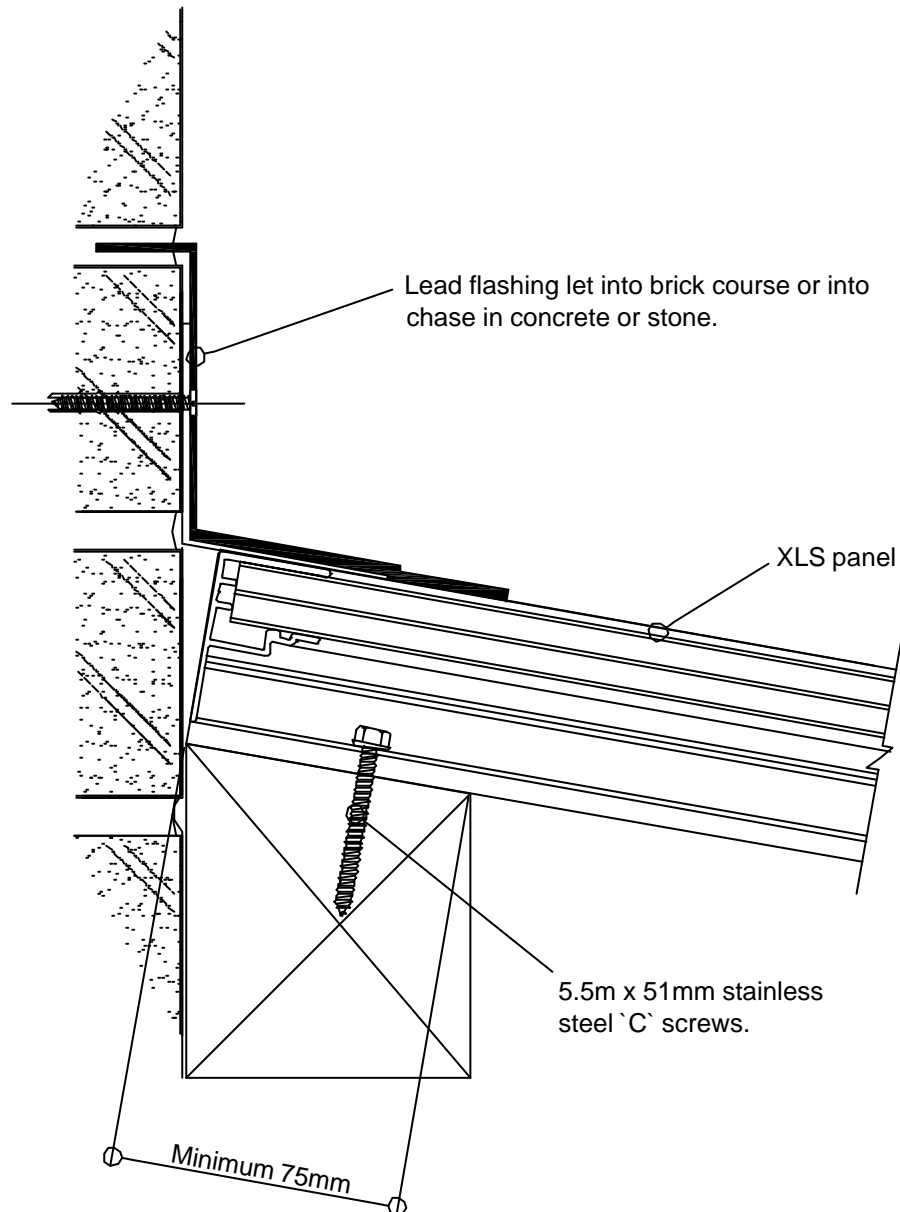

Typical XLS panel head detail
minimum pitch 10°
Preferred



Xtralite
ROOFLIGHTS

XTRALITE (ROOFLIGHTS) LTD.
SPENCER ROAD,
BLYTH INDUSTRIAL ESTATE,
BLYTH,
NORTHUMBERLAND,
NE24 5TF
E-mail Drawings@xtralite.co.uk
Tel No. (01670) 354157
Fax No. (01670) 364875
International Tel No. (0044) 1670 354157
International fax No. (0044) 1670 364875

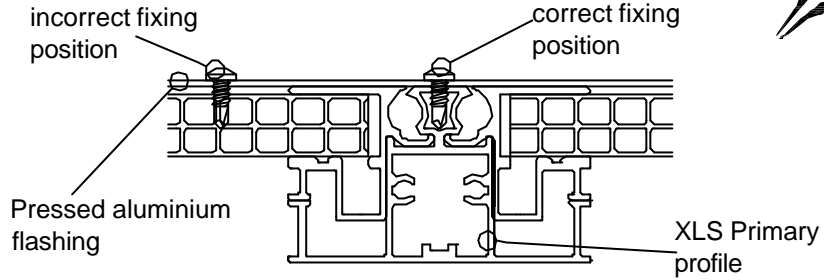

Pressed aluminium
fixing position to main
profile (see below).

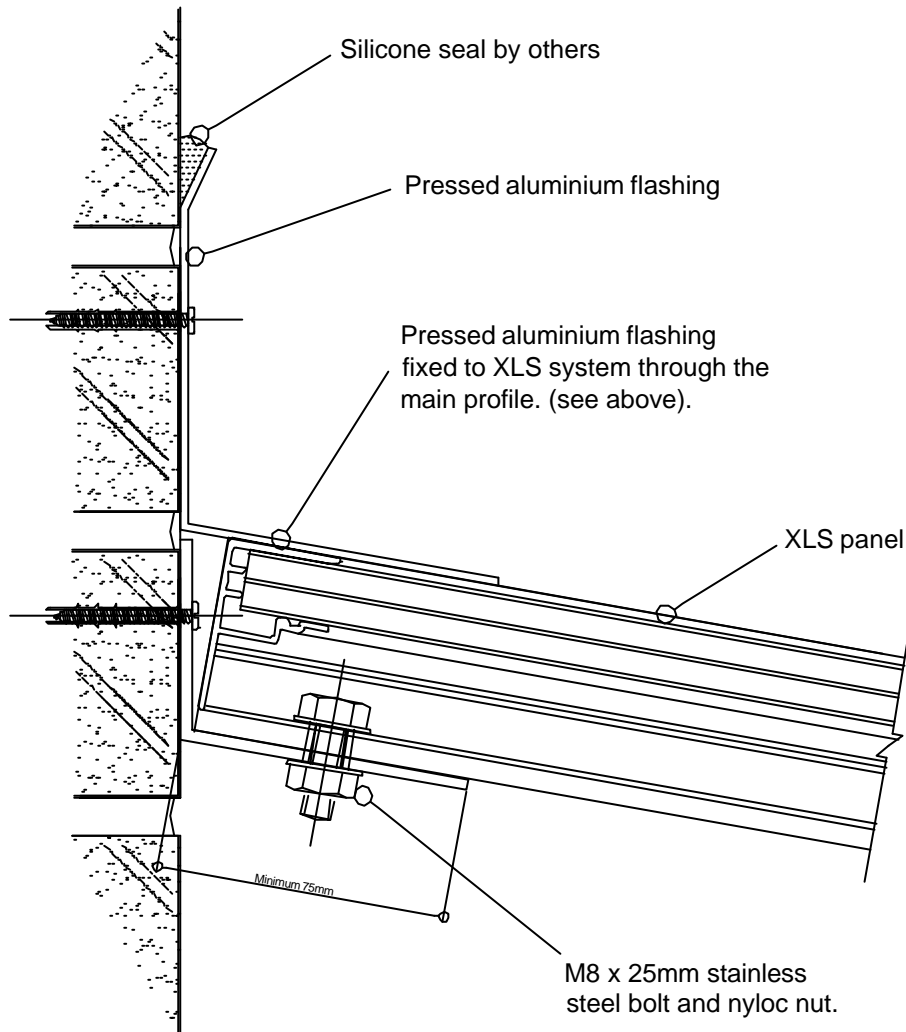

Typical XLS panel head detail
minimum pitch 10°
Non preferred



Xtralite
ROOFLIGHTS

XTRALITE (ROOFLIGHTS) LTD.
SPENCER ROAD,
BLYTH INDUSTRIAL ESTATE,
BLYTH,
NORTHUMBERLAND,
NE24 5TF
E-mail Drawings@xtralite.co.uk
Tel No. (01670) 354157
Fax No. (01670) 364875
International Tel No. (0044) 1670 354157
International fax No. (0044) 1670 364875

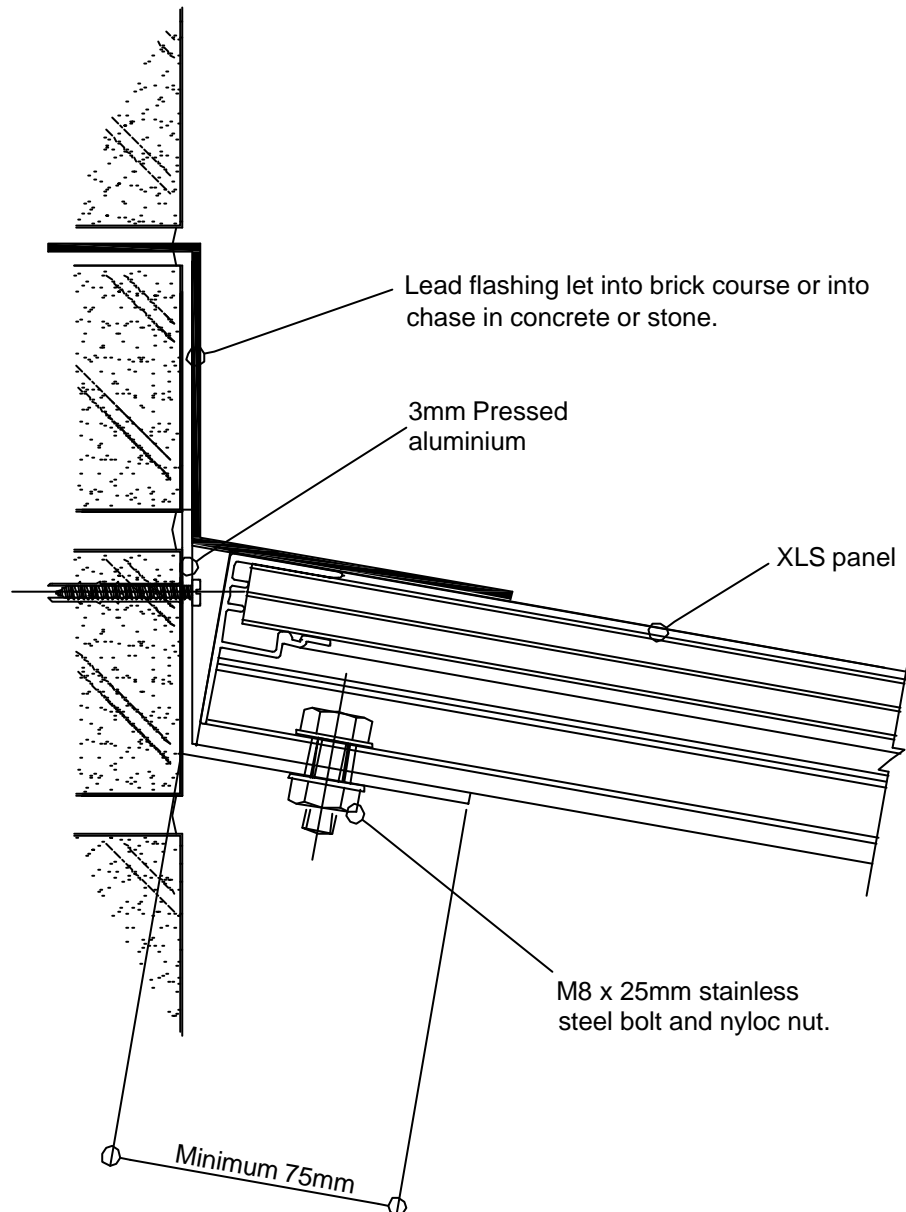

Typical XLS panel head detail
minimum pitch 10°
Preferred



Xtralite
ROOFLIGHTS

XTRALITE (ROOFLIGHTS) LTD.
SPENCER ROAD,
BLYTH INDUSTRIAL ESTATE,
BLYTH,
NORTHUMBERLAND,
NE24 5TF
E-mail Drawings@xtralite.co.uk
Tel No. (01670) 354157
Fax No. (01670) 364875
International Tel No. (0044) 1670 354157
International fax No. (0044) 1670 364875

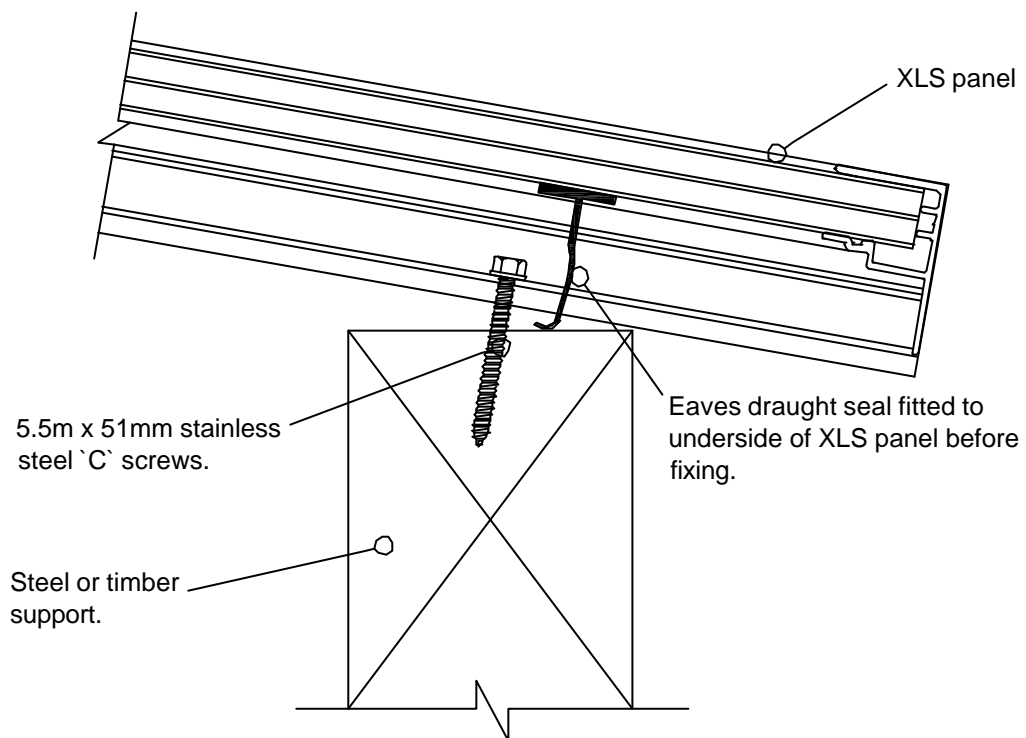

Typical XLS panel eaves detail
minimum pitch 10°



Xtralite
ROOFLIGHTS

XTRALITE (ROOFLIGHTS) LTD.
SPENCER ROAD,
BLYTH INDUSTRIAL ESTATE,
BLYTH,
NORTHUMBERLAND,
NE24 5TF
E-mail Drawings@xtralite.co.uk
Tel No. (01670) 354157
Fax No. (01670) 364875
International Tel No. (0044) 1670 354157
International fax No. (0044) 1670 364875

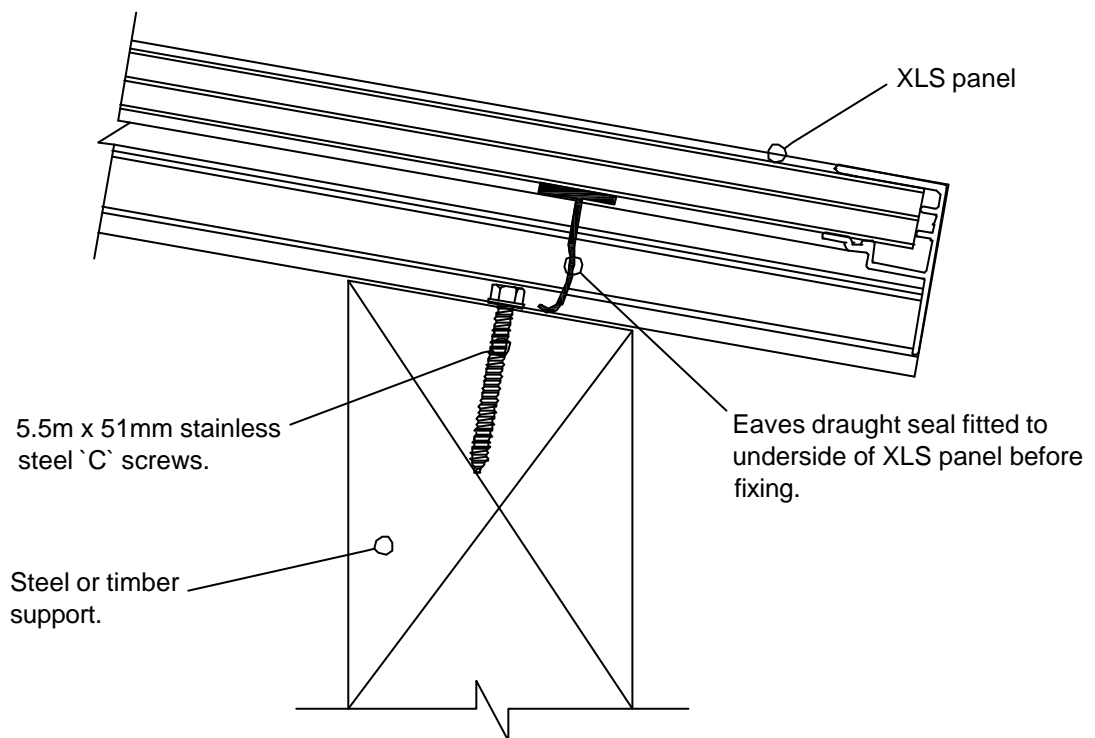

Typical XLS panel eaves detail
minimum pitch 10°
Preferred



Xtralite
ROOFLIGHTS

XTRALITE (ROOFLIGHTS) LTD.
SPENCER ROAD,
BLYTH INDUSTRIAL ESTATE,
BLYTH,
NORTHUMBERLAND,
NE24 5TF
E-mail Drawings@xtralite.co.uk
Tel No. (01670) 354157
Fax No. (01670) 364875
International Tel No. (0044) 1670 354157
International fax No. (0044) 1670 364875

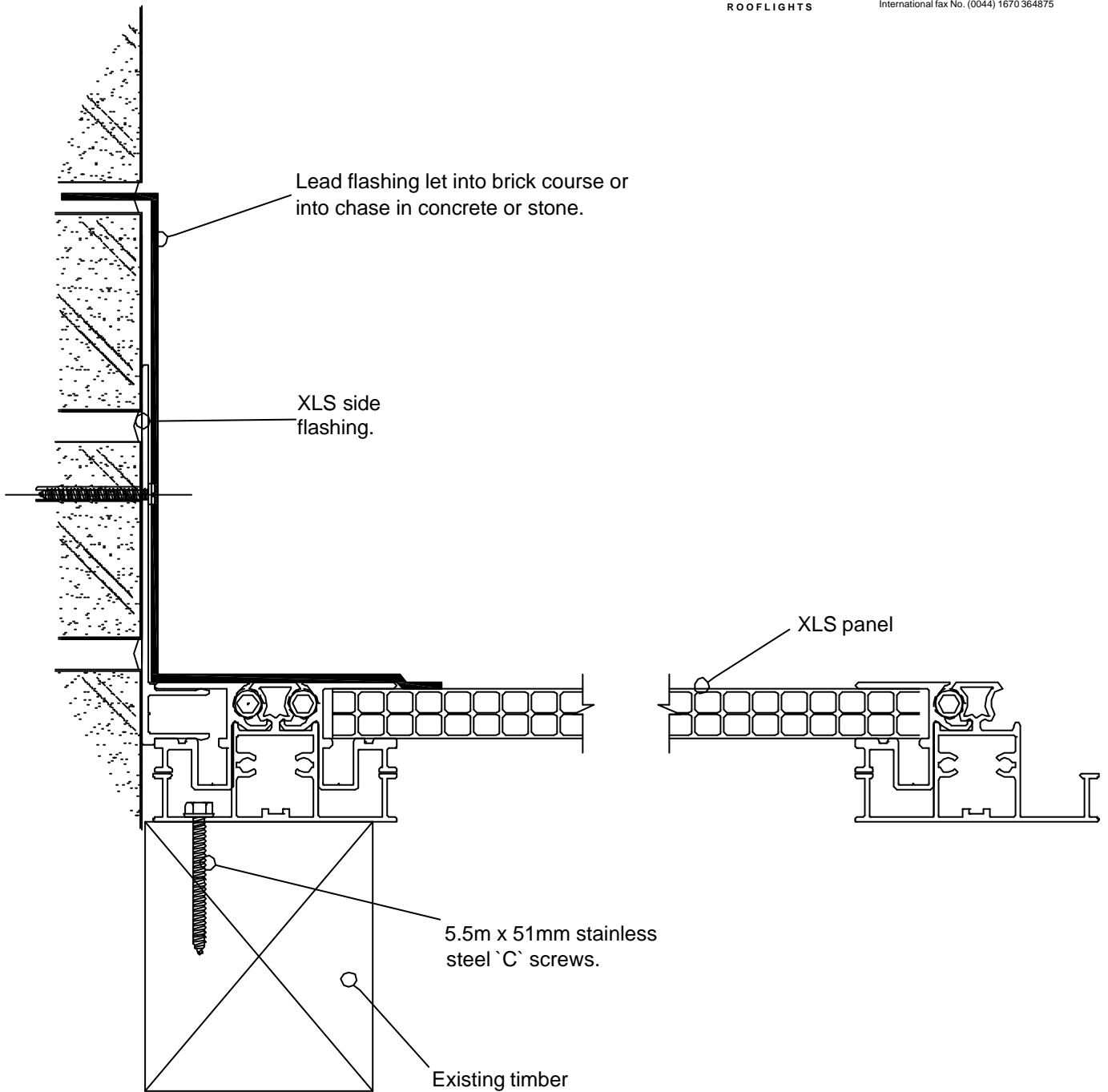

Typical XLS panel wall
abutment detail



Xtralite
ROOFLIGHTS

XTRALITE (ROOFLIGHTS) LTD.
SPENCER ROAD,
BLYTH INDUSTRIAL ESTATE,
BLYTH,
NORTHUMBERLAND,
NE24 5TF
E-mail Drawings@xtralite.co.uk
Tel No. (01670) 354157
Fax No. (01670) 364875
International Tel No. (0044) 1670 354157
International fax No. (0044) 1670 364875

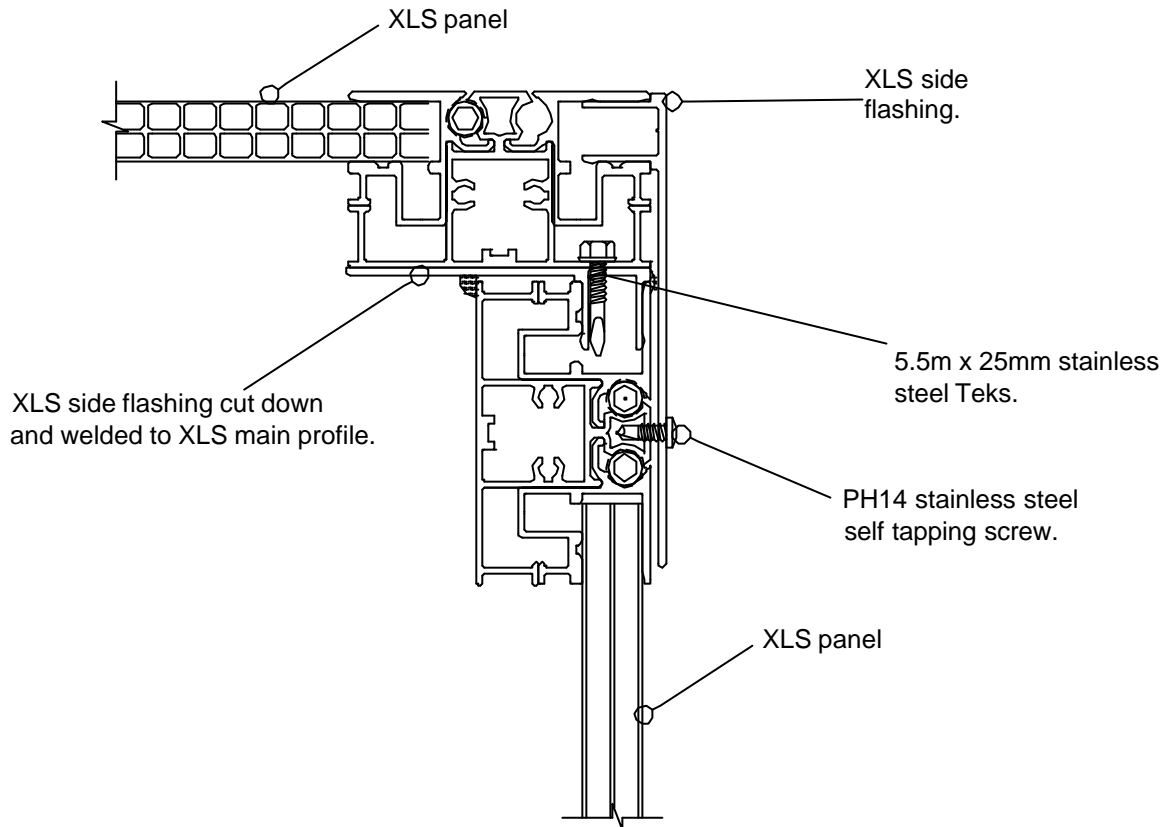

Typical XLS small gable
end detail



Xtralite
ROOFLIGHTS

XTRALITE (ROOFLIGHTS) LTD.
SPENCER ROAD,
BLYTH INDUSTRIAL ESTATE,
BLYTH,
NORTHUMBERLAND,
NE24 5TF
E-mail Drawings@xtralite.co.uk
Tel No. (01670) 354157
Fax No. (01670) 364875
International Tel No. (0044) 1670 354157
International fax No. (0044) 1670 364875

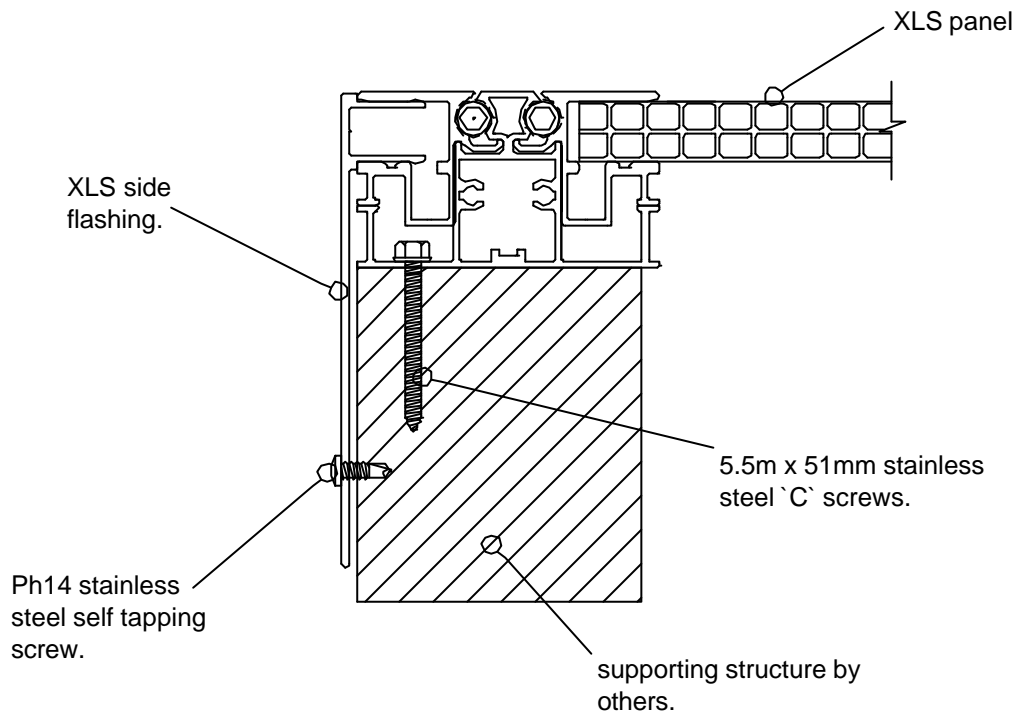

Typical XLS panel
side detail



Xtralite
ROOFLIGHTS

XTRALITE (ROOFLIGHTS) LTD.
SPENCER ROAD,
BLYTH INDUSTRIAL ESTATE,
BLYTH,
NORTHUMBERLAND,
NE24 5TF
E-mail Drawings@xtralite.co.uk
Tel No. (01670) 354157
Fax No. (01670) 364875
International Tel No. (0044) 1670 354157
International fax No. (0044) 1670 364875

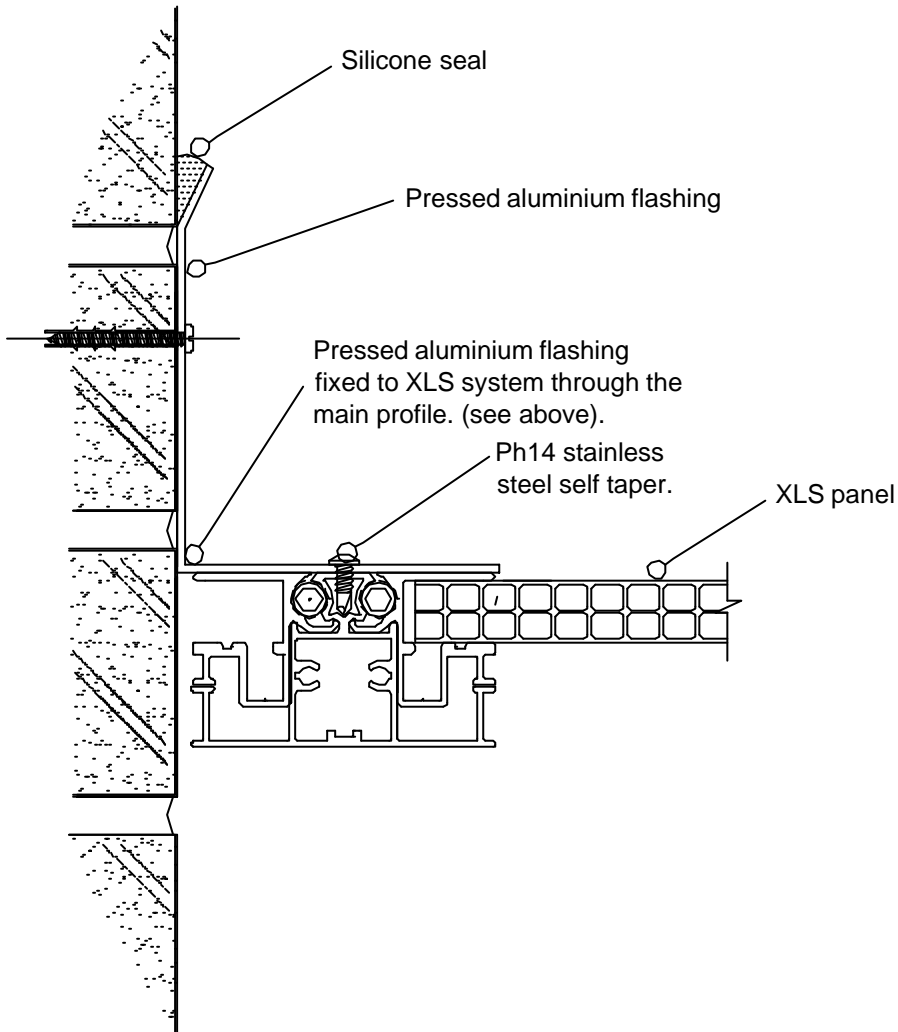

Typical XLS panel wall
abutment detail
Non preferred



Xtralite
ROOFLIGHTS

XTRALITE (ROOFLIGHTS) LTD.
SPENCER ROAD,
BLYTH INDUSTRIAL ESTATE,
BLYTH,
NORTHUMBERLAND,
NE24 5TF
E-mail Drawings@xtralite.co.uk
Tel No. (01670) 354157
Fax No. (01670) 364875
International Tel No. (0044) 1670 354157
International fax No. (0044) 1670 364875

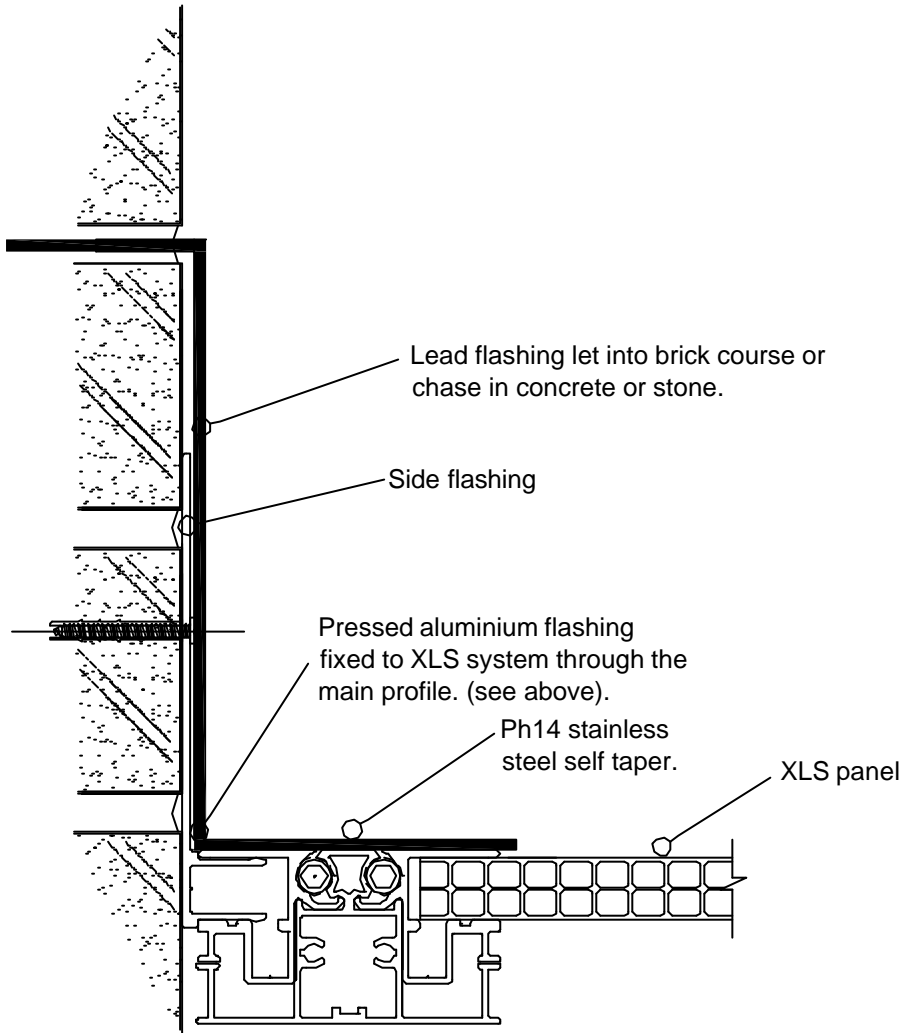

Typical wall
abutment detail
Preferred



Xtralite
ROOFLIGHTS

XTRALITE (ROOFLIGHTS) LTD.
SPENCER ROAD,
BLYTH INDUSTRIAL ESTATE,
BLYTH,
NORTHUMBERLAND,
NE24 5TF
E-mail Drawings@xtralite.co.uk
Tel No. (01670) 354157
Fax No. (01670) 364875
International Tel No. (0044) 1670 354157
International fax No. (0044) 1670 364875

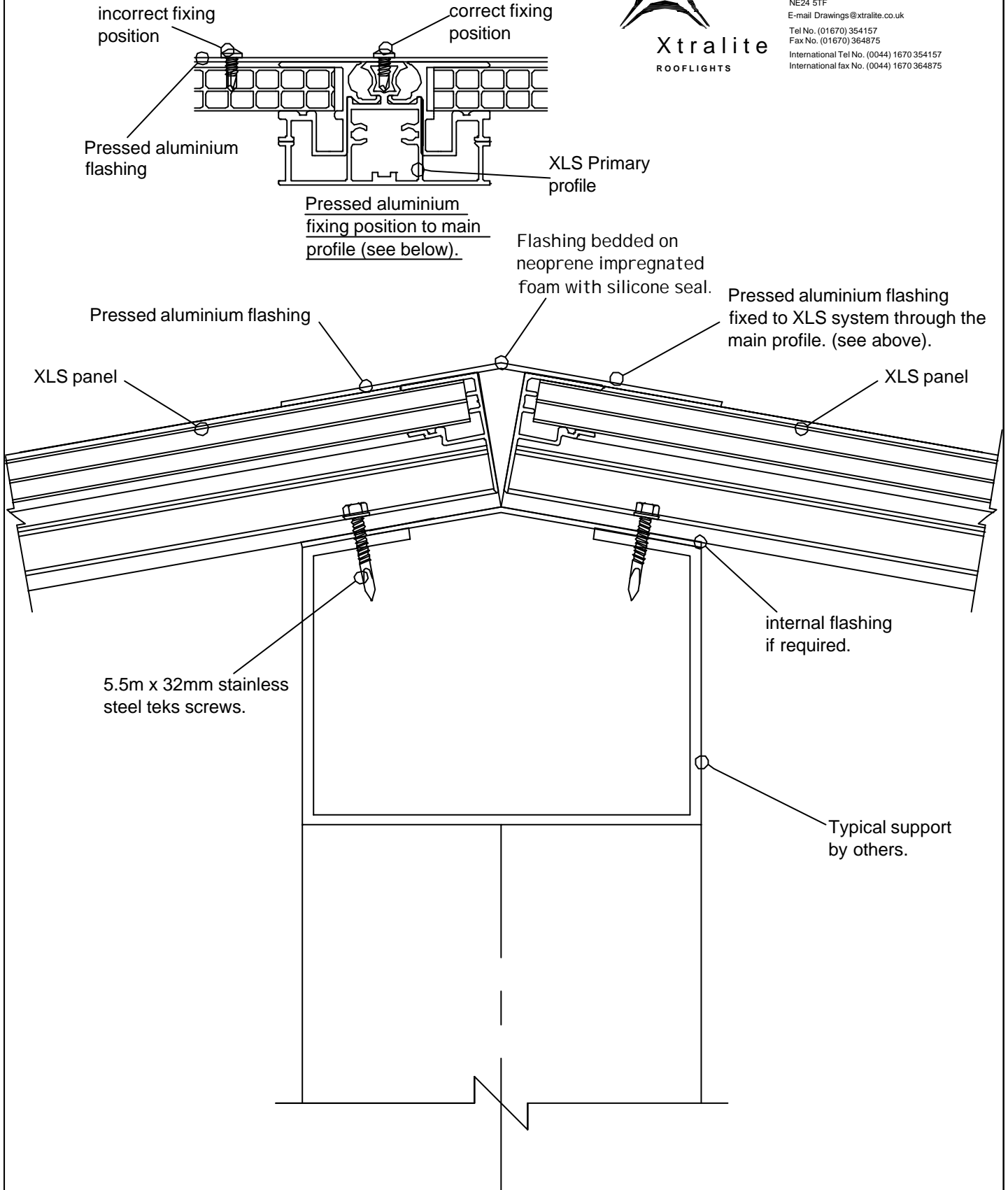

Typical XLS panel ridge detail



Xtralite
ROOFLIGHTS

XTRALITE (ROOFLIGHTS) LTD.
SPENCER ROAD,
BLYTH INDUSTRIAL ESTATE,
BLYTH,
NORTHUMBERLAND,
NE24 5TF
E-mail Drawings@xtralite.co.uk
Tel No. (01670) 354157
Fax No. (01670) 364875
International Tel No. (0044) 1670 354157
International fax No. (0044) 1670 364875

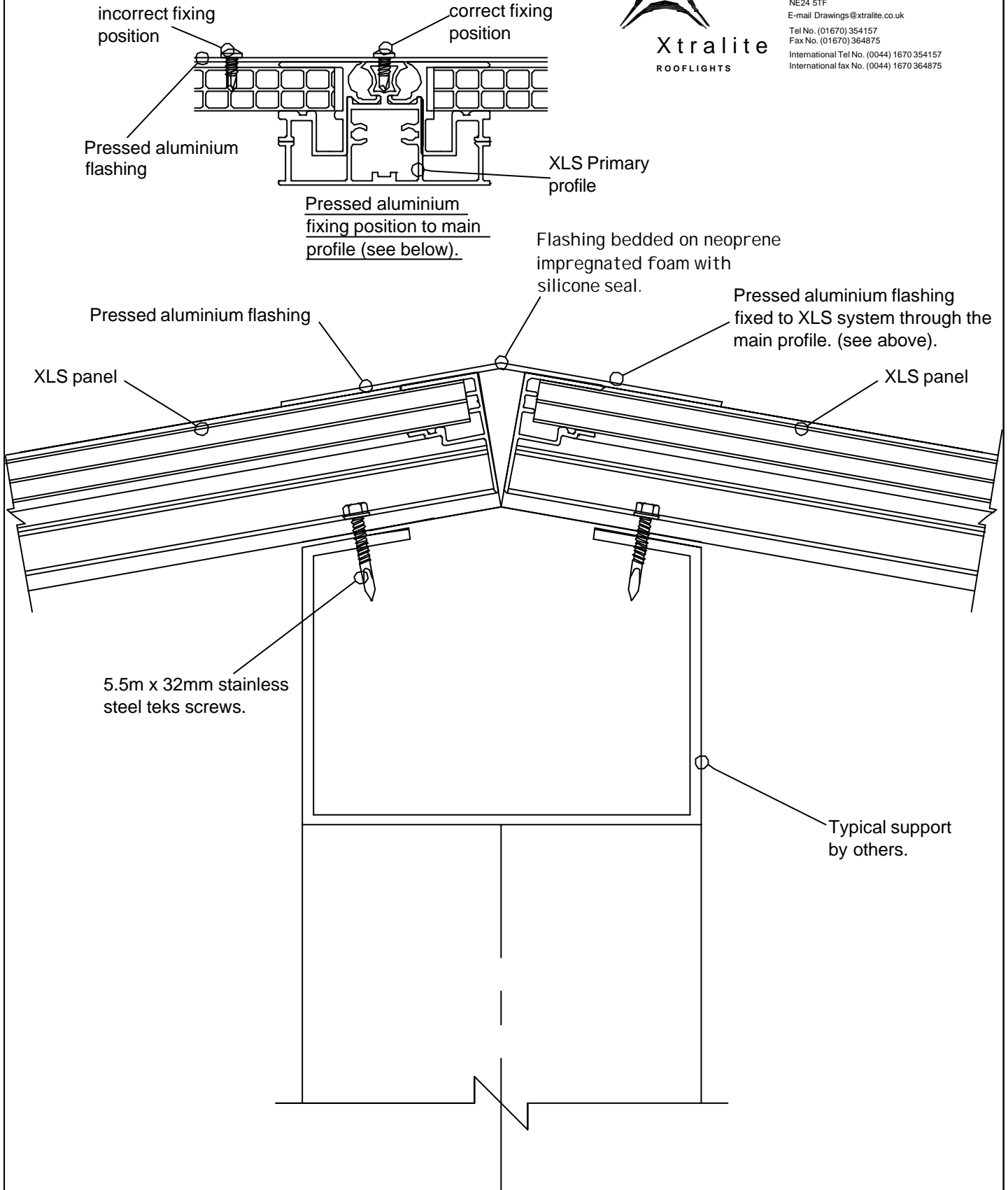

Typical XLS panel ridge detail



Xtralite
ROOFLIGHTS

XTRALITE (ROOFLIGHTS) LTD.
SPENCER ROAD,
BLYTH INDUSTRIAL ESTATE,
BLYTH,
NORTHUMBERLAND,
NE24 5TF
E-mail Drawings@xtralite.co.uk
Tel No. (01670) 354157
Fax No. (01670) 364875
International Tel No. (0044) 1670 354157
International fax No. (0044) 1670 364875

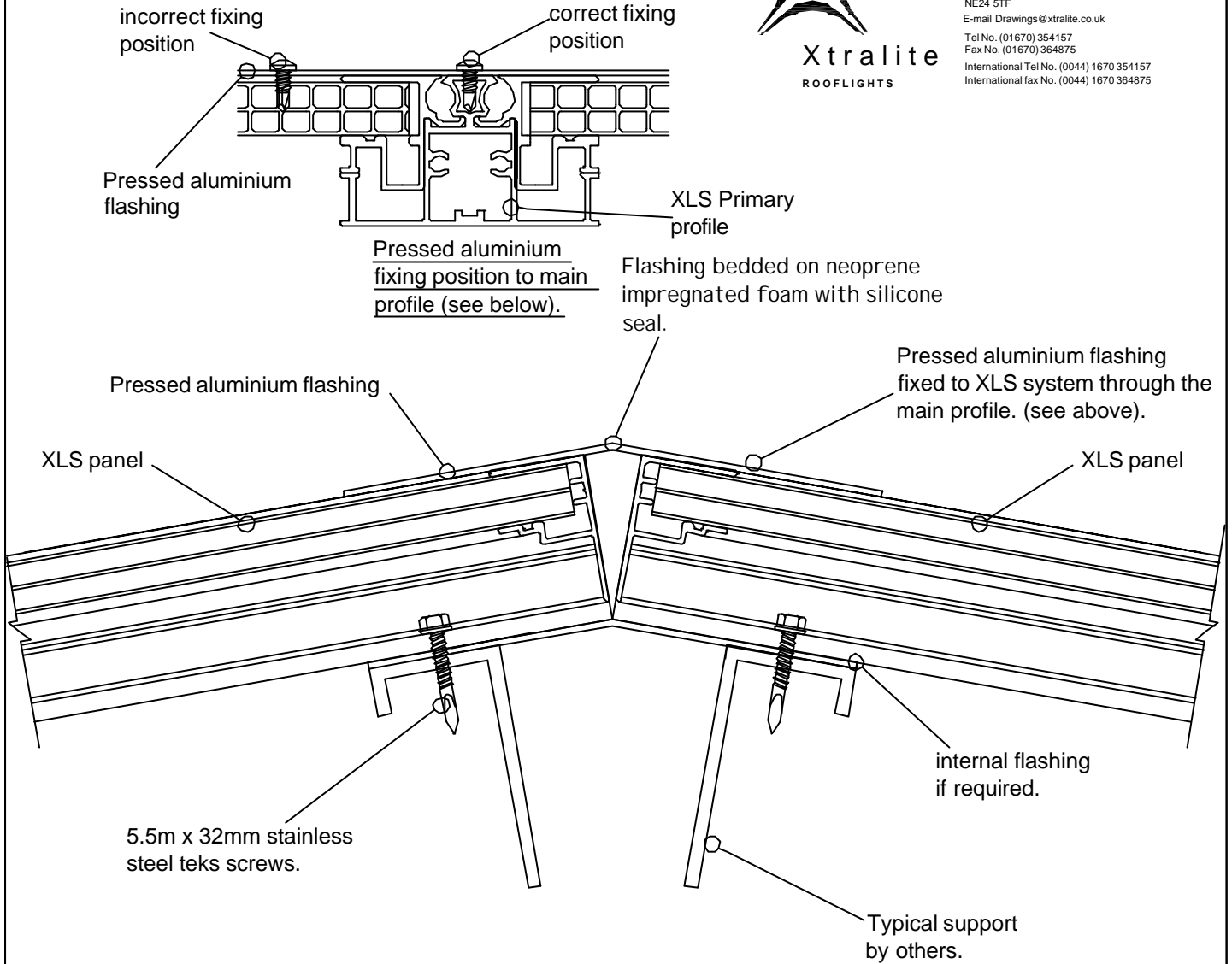

Typical XLS panel ridge detail

Eaves draught seal fitted to underside of XLS panel before fixing.

XLS panel

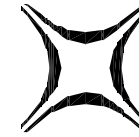

Xtralite
ROOFLIGHTS

XTRALITE (ROOFLIGHTS) LTD.
SPENCER ROAD,
BLYTH INDUSTRIAL ESTATE,
BLYTH,
NORTHUMBERLAND,
NE24 5TF
E-mail Drawings@xtralite.co.uk
Tel No. (01670) 354157
Fax No. (01670) 364875
International Tel No. (0044) 1670 354157
International fax No. (0044) 1670 364875

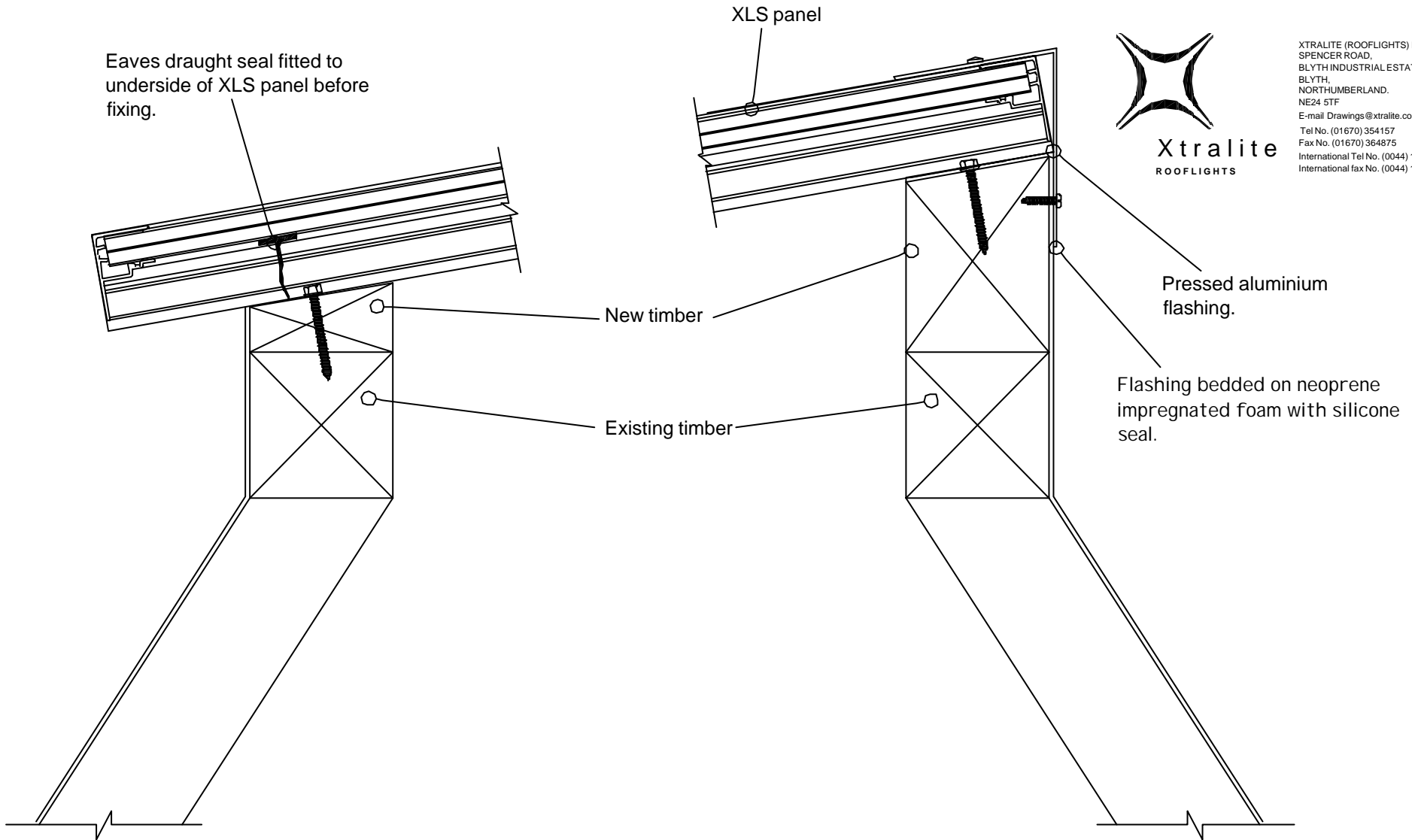

Glazing to existing timber frame
minimum pitch 10°



Xtralite
ROOFLIGHTS

XTRALITE (ROOFLIGHTS) LTD.
SPENCER ROAD,
BLYTH INDUSTRIAL ESTATE,
BLYTH,
NORTHUMBERLAND.
NE24 5TF
E-mail Drawings@xtralite.co.uk
Tel No. (01670) 354157
Fax No. (01670) 364875
International Tel No. (0044) 1670 354157
International fax No. (0044) 1670 364875

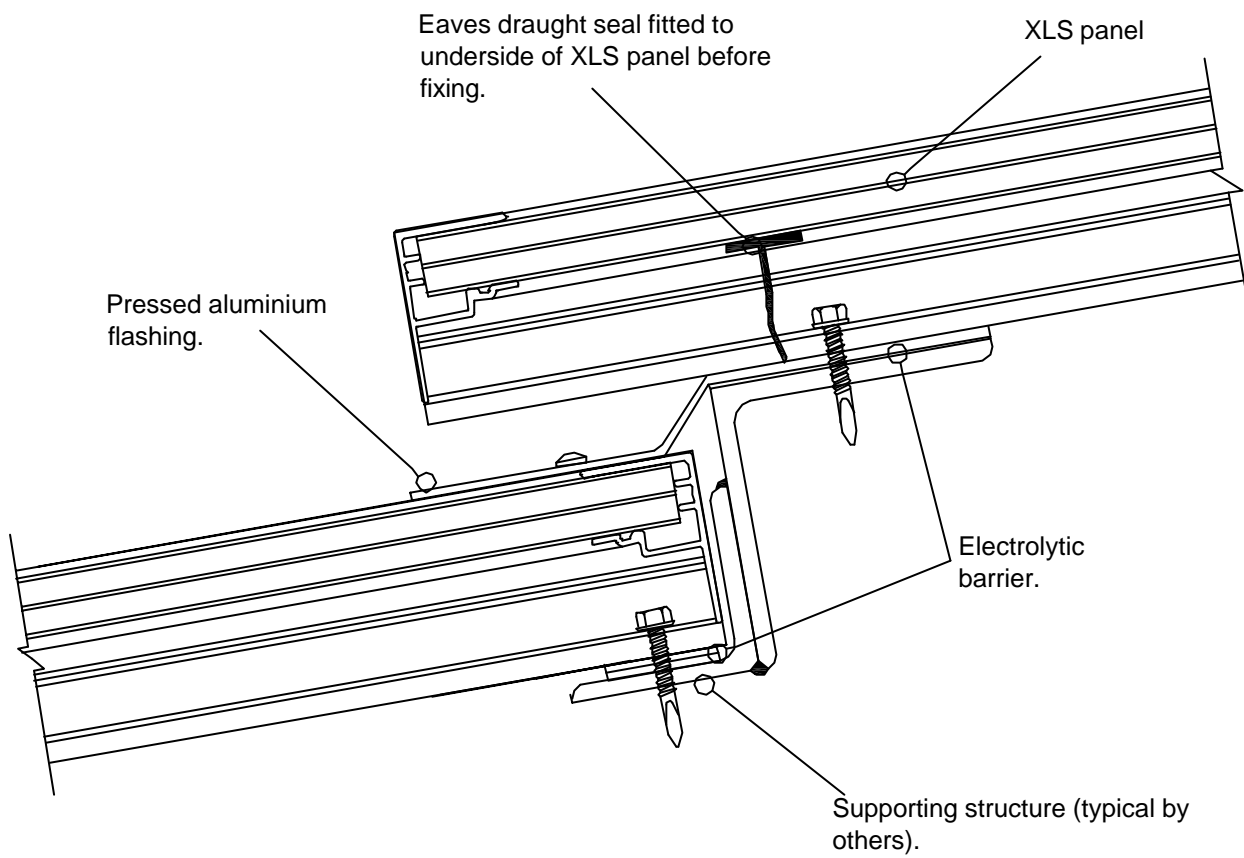

Typical detail for XLS panel overlap
minimum pitch 10°

Ref No 24
issue A



Xtralite
ROOFLIGHTS

XTRALITE (ROOFLIGHTS) LTD.
SPENCER ROAD,
BLYTH INDUSTRIAL ESTATE,
BLYTH,
NORTHUMBERLAND,
NE24 5TF
E-mail Drawings@xtralite.co.uk
Tel No. (01670) 354157
Fax No. (01670) 364875
International Tel No. (0044) 1670 354157
International fax No. (0044) 1670 364875

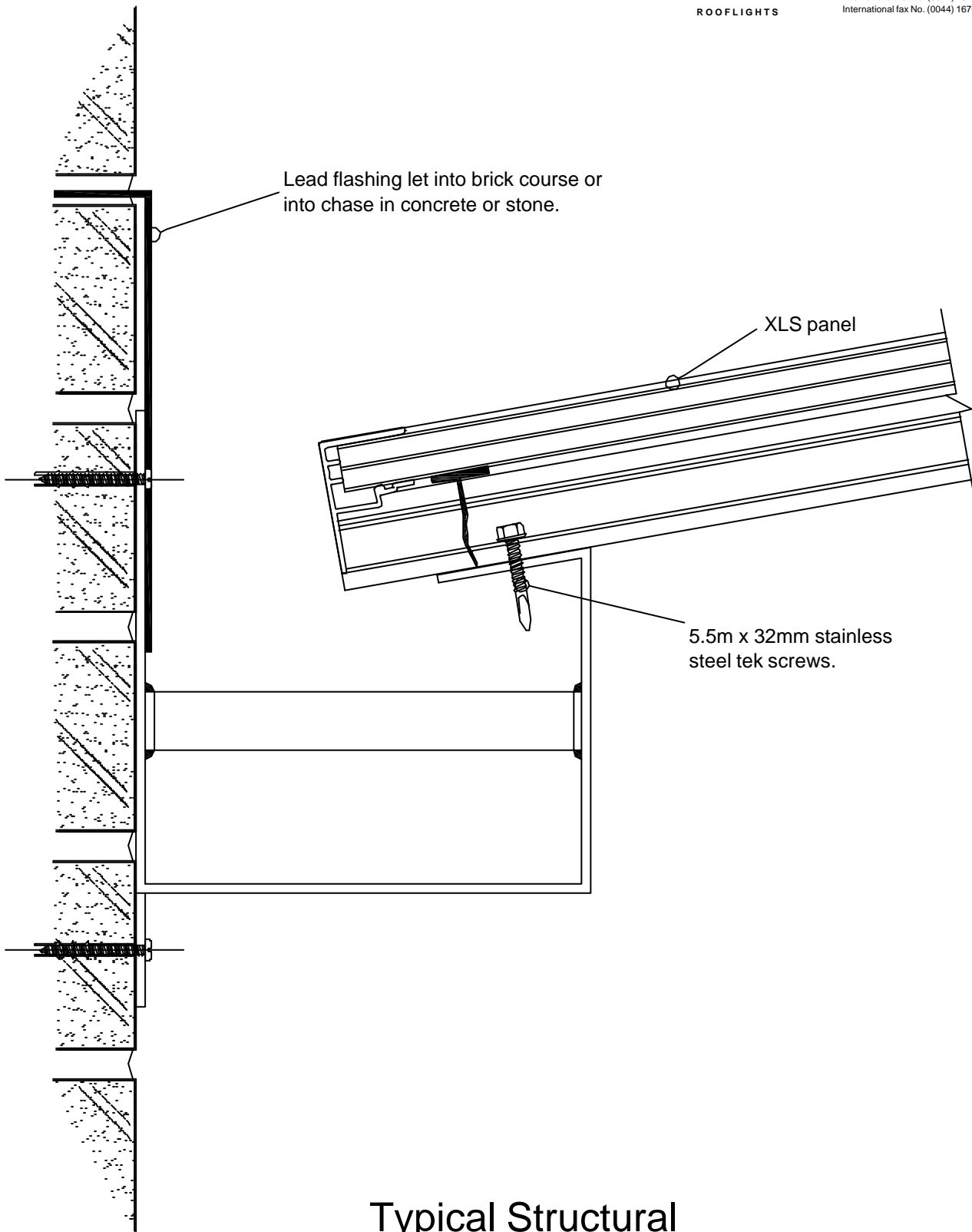

Lead flashing let into brick course or
into chase in concrete or stone.

XLS panel

5.5m x 32mm stainless
steel tek screws.

Typical Structural
gutter detail

Ref No 25
issue B

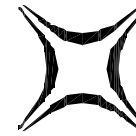

Xtralite
ROOFLIGHTS

XTRALITE (ROOFLIGHTS) LTD.
SPENCER ROAD,
BLYTH INDUSTRIAL ESTATE,
BLYTH,
NORTHUMBERLAND,
NE24 5TF
E-mail Drawings@xtralite.co.uk
Tel No. (01670) 354157
Fax No. (01670) 364875
International Tel No. (0044) 1670 354157
International fax No. (0044) 1670 364875

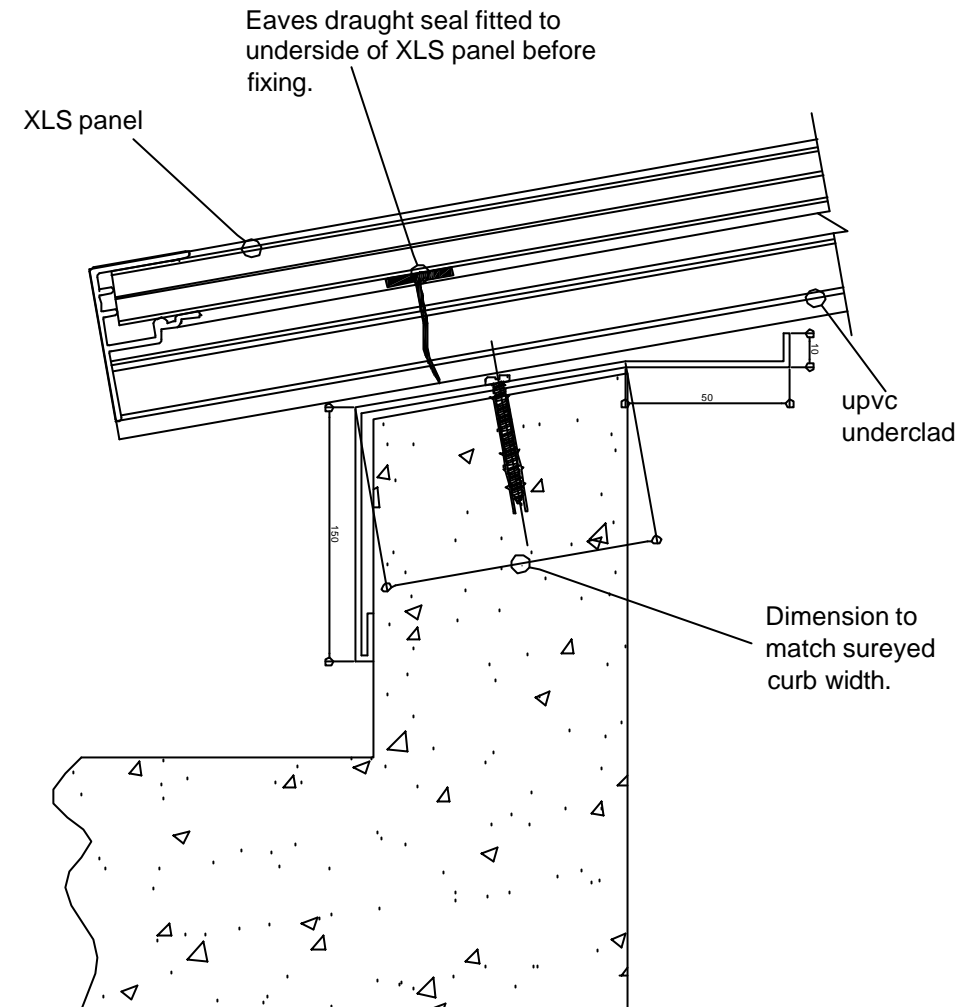
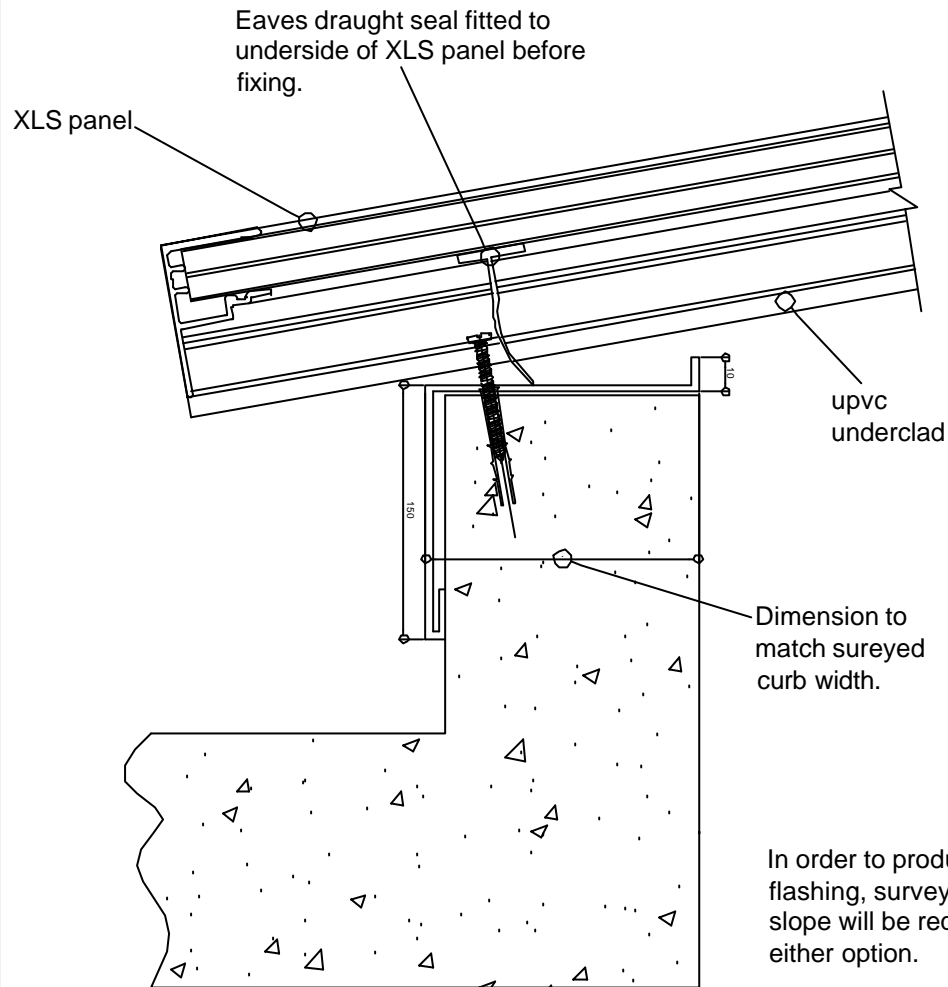

In order to produce curb flashing, survey of curb & slope will be required for either option.

Typical curb flashings

Ref No 26
issue A



Xtralite
ROOFLIGHTS

XTRALITE (ROOFLIGHTS) LTD.
SPENCER ROAD,
BLYTH INDUSTRIAL ESTATE,
BLYTH,
NORTHUMBERLAND,
NE24 5TF
E-mail Drawings@xtralite.co.uk
Tel No. (01670) 354157
Fax No. (01670) 364875
International Tel No. (0044) 1670 354157
International fax No. (0044) 1670 364875

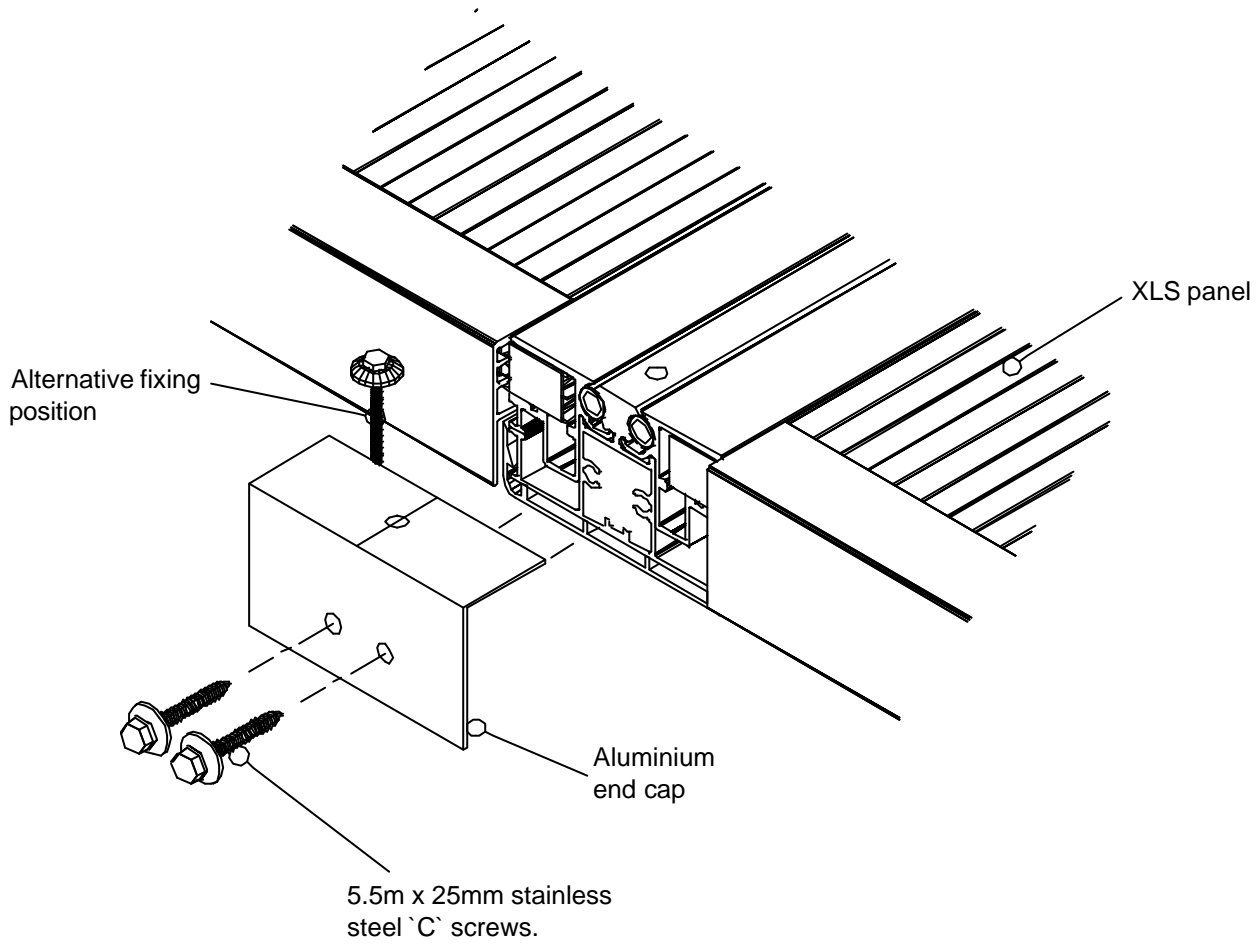

XLS system end cap fixing



Xtralite
ROOFLIGHTS

XTRALITE (ROOFLIGHTS) LTD.
SPENCER ROAD,
BLYTH INDUSTRIAL ESTATE,
BLYTH,
NORTHUMBERLAND,
NE24 5TF
E-mail Drawings@xtralite.co.uk
Tel No. (01670) 354157
Fax No. (01670) 364875
International Tel No. (0044) 1670 354157
International fax No. (0044) 1670 364875

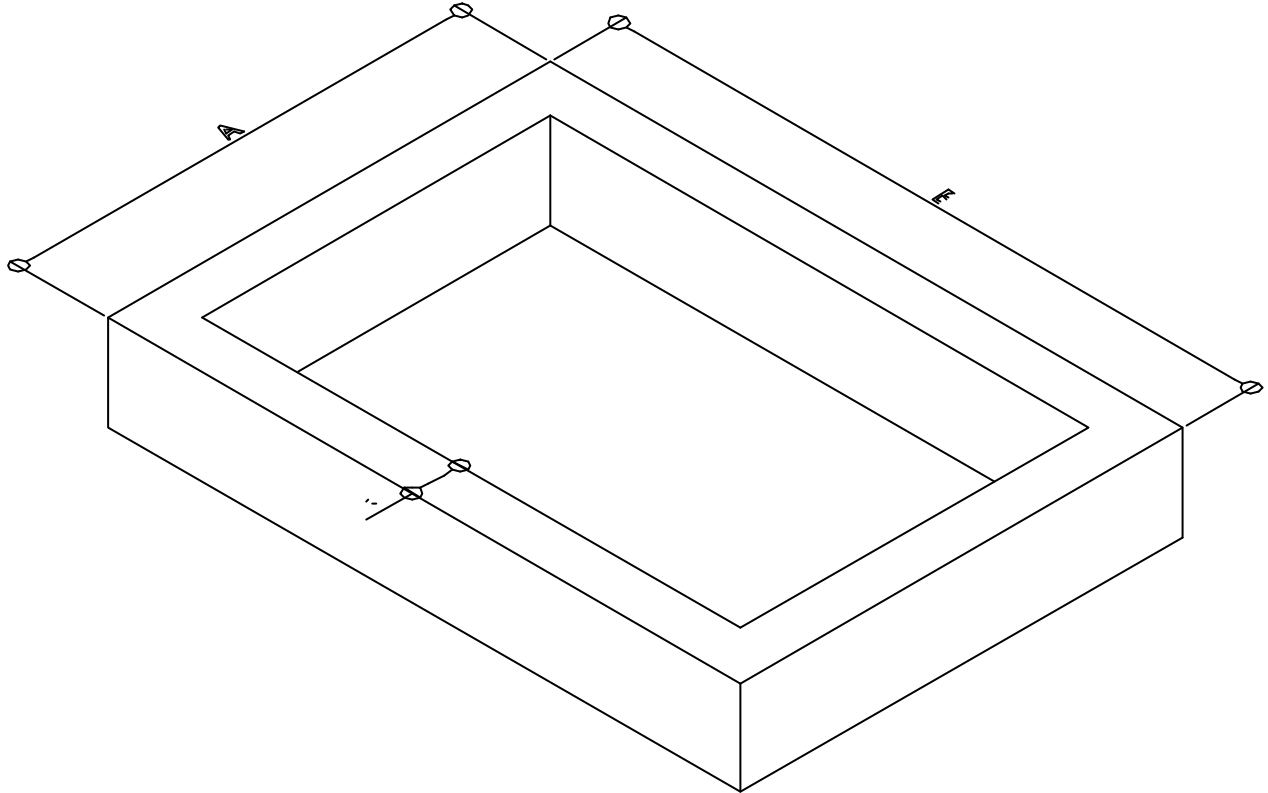

NOTE!
Minimum pitch of 10°
needs to be created.

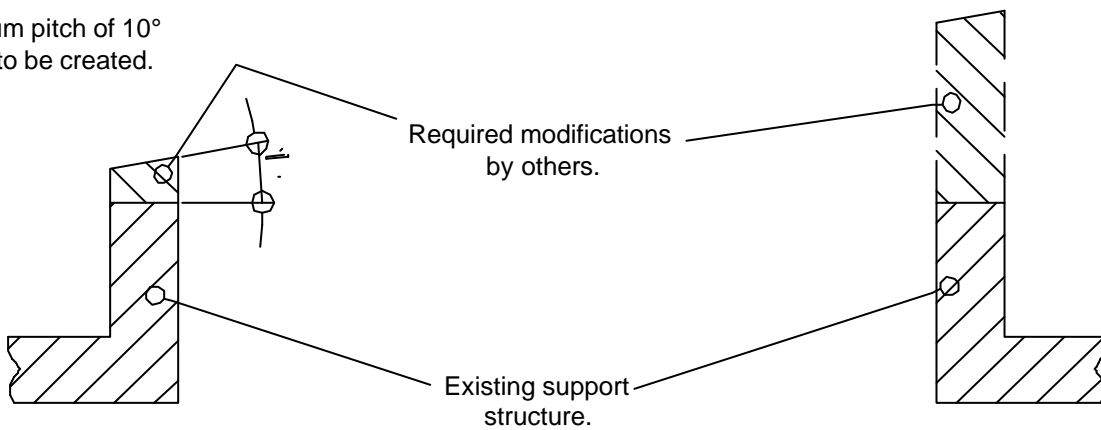

Survey guide Single roof opening

FIXING INSTRUCTION FOR STARTER PANEL

Co-extruded draught excluder bonded to panel NOT upstand.

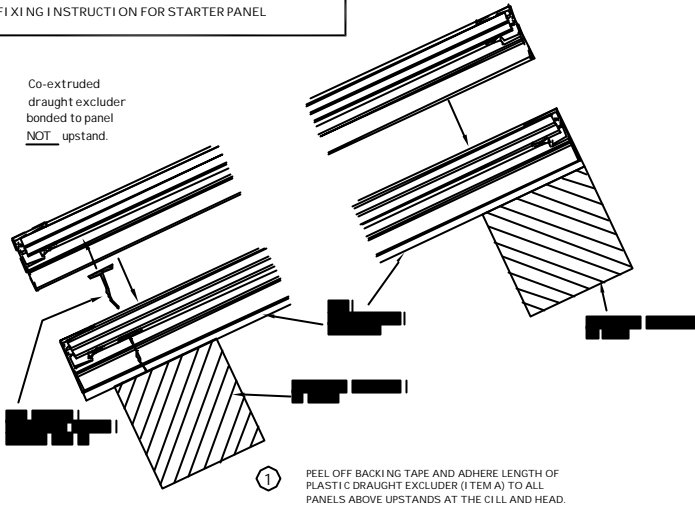

1 PEEL OFF BACKING TAPE AND ADHERE LENGTH OF PLASTIC DRAUGHT EXCLUDER (ITEM A) TO ALL PANELS ABOVE UPSTANDS AT THE SILL AND HEAD.

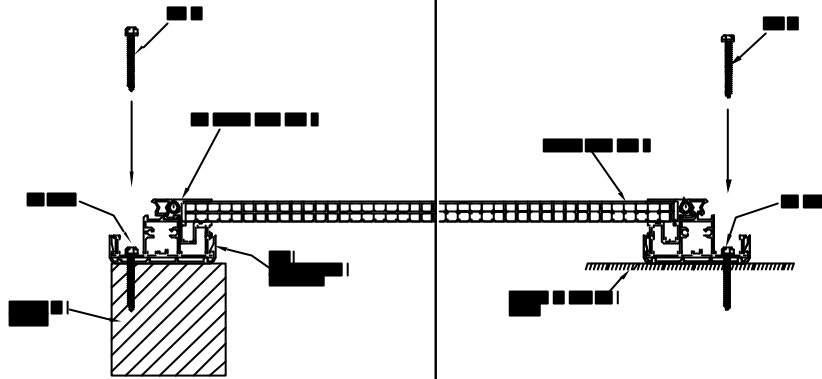

2 FIX XLS STARTER PANEL (ITEM B) TO ONE END OF THE STRUCTURE AT THE SIDES USING 'C' SCREWS (ITEM C).

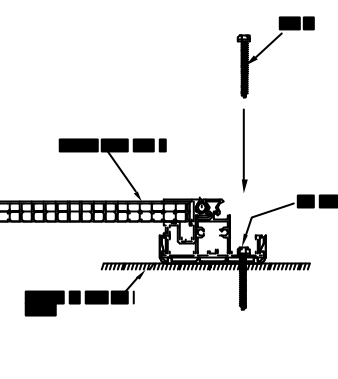

3 FIX OPPOSITE SIDE OF STARTER PANEL (ITEM B) TO THE UPSTAND USING 'C' SCREWS (ITEM C).

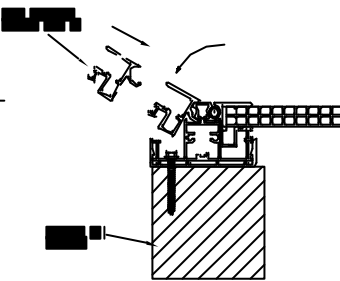

4 PUSH IN SIDE FLASHING ADAPTOR (ITEM D) AND ROTATE AS INDICATED.

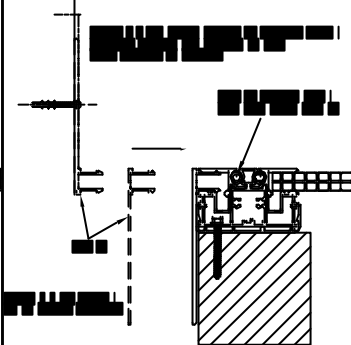

5 LOCK IN (ITEM D) FLASHING ADAPTOR WITH 10 MM GRUB SCREW (ITEM E) AND PUSH IN SIDE FLASHING (ITEM F) AS REQUIRED OPTION A OR B.

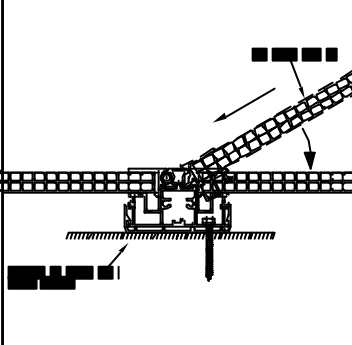

6 INSERT XLS PANEL (ITEM G) AND ROTATE INTO POSITION AS INDICATED.

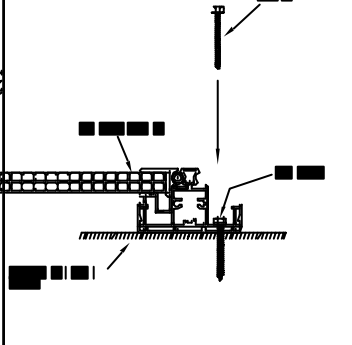

7 FIX OPPOSITE END OF XLS PANEL (ITEM G) TO THE UPSTAND USING 'C' SCREWS (ITEM C).

REPEAT STEPS 6 & 7 UNTIL ALL XLS PANELS HAVE BEEN LAYED.

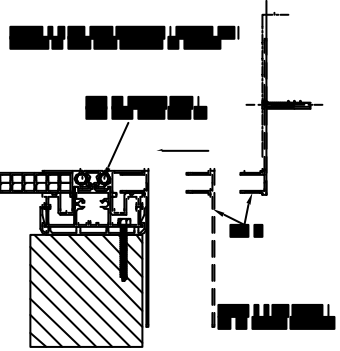

8 LOCK IN (ITEM D) FLASHING ADAPTOR WITH 10 MM GRUB SCREW (ITEM E) AND PUSH IN SIDE FLASHING (ITEM F) AS REQUIRED OPTION A OR B.

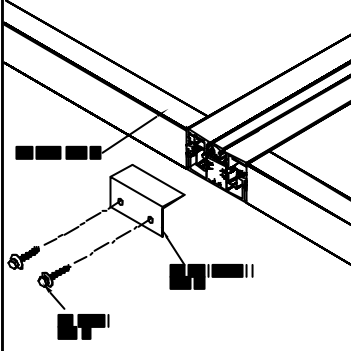

9 LOCATE ALUMINIUM CLOSURE (ITEM H) OVER LOWER EAVES SIDE OF XLS PANELS (ITEM G) & FIX USING 'C' SCREW (ITEM I).

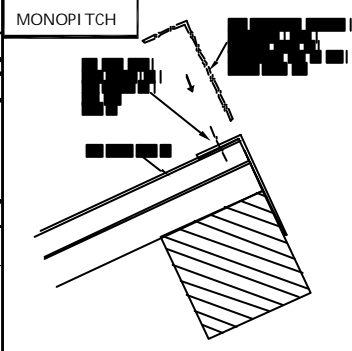

10 LOCATE PRESSED ALUMINIUM HEAD FLASHING (ITEM J) OVER UPPER EAVES SIDE OF XLS PANELS (ITEM G) & FIX USING POP RIVETS (ITEM K).

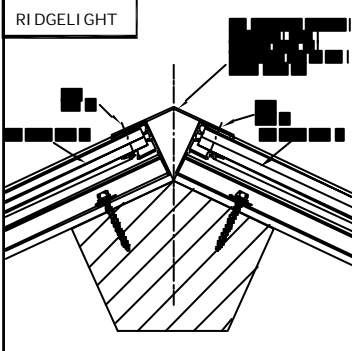

11 LOCATE PRESSED ALUMINIUM RIDGE FLASHING (ITEM L) OVER RIDGE OF XLS PANELS (ITEM G) & FIX USING POP RIVETS (ITEM K).

IMPORTANT NOTES:

Prior to installation / First Fix of the unit, the xls starter panel and all associated panels should be loosefit, without any fixings onto the kerb to ensure the starter panel is square to the kerb. It is highly likely that should the above not be completed prior to permanent fixing then the unit may run 'Off Line' on the kerb.

NOTES:
ALL DIMENSIONS MUST BE CHECKED ON SITE AND NOT SCALED FROM THIS DRAWING.

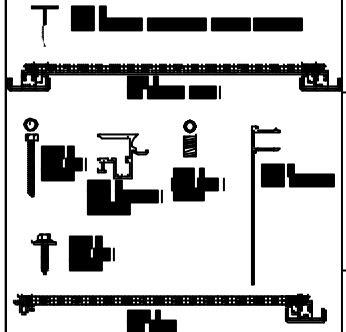

ITEM J IS ONLY SUPPLIED WITH MONOPI TCH ROOFLIGHTS.
ITEM L IS ONLY SUPPLIED WITH RIDGELIGHT ROOFLIGHTS.



XLS FIXING INSTRUCTIONS

XLS FIXING INSTRUCTIONS

FIXING INSTRUCTION FOR STARTER PANEL

Co-extruded draught excluder bonded to panel NOT upstand.

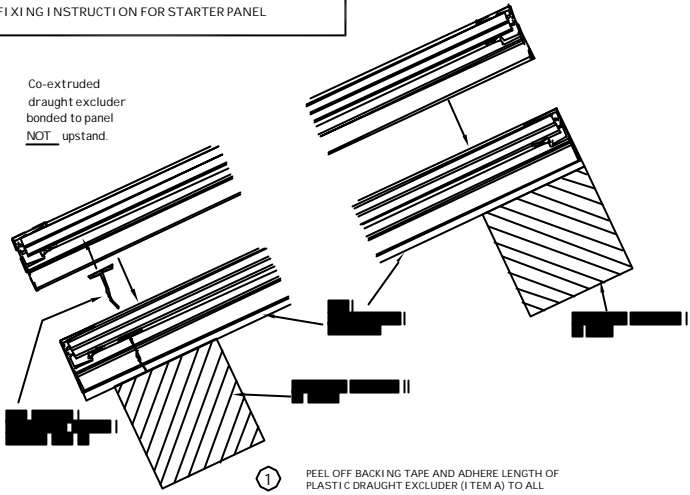

1 PEEL OFF BACKING TAPE AND ADHERE LENGTH OF PLASTIC DRAUGHT EXCLUDER (ITEM A) TO ALL PANELS ABOVE UPSTANDS AT THE SILL AND HEAD.

2 FIX XLS STARTER PANEL (ITEM B) TO ONE END OF THE STRUCTURE AT THE SIDES USING 'C' SCREWS (ITEM C).

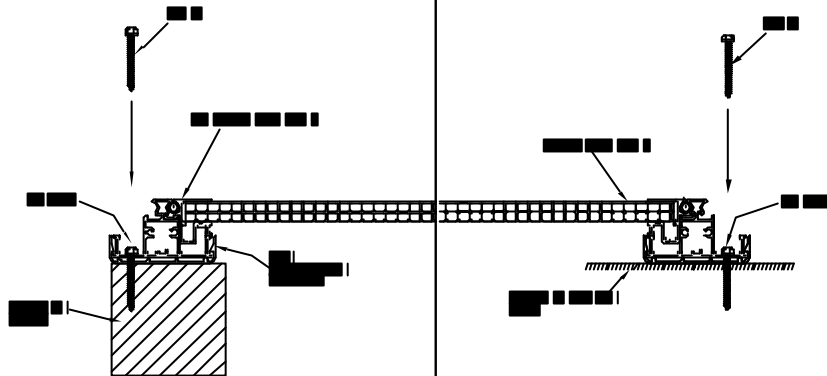

3 FIX OPPOSITE SIDE OF STARTER PANEL (ITEM B) TO THE UPSTAND USING 'C' SCREWS (ITEM C).

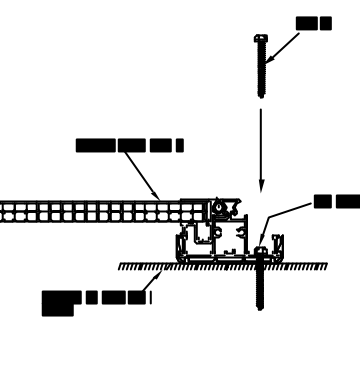

NOTES:
ALL DIMENSIONS MUST BE CHECKED ON SITE AND NOT SCALED FROM THIS DRAWING.

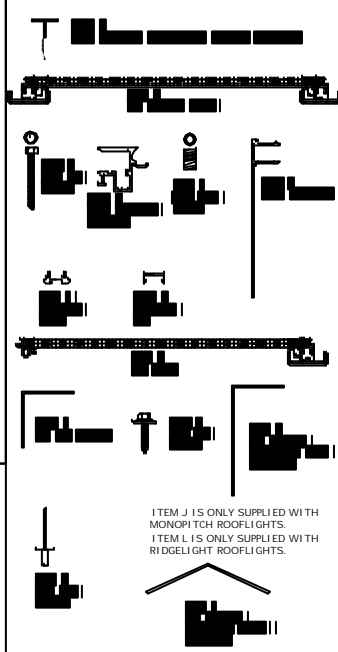

ITEM J IS ONLY SUPPLIED WITH MONOPITCH ROOFLIGHTS.
ITEM L IS ONLY SUPPLIED WITH RIDGELIGHT ROOFLIGHTS.

REPEAT STEPS 4 UNTIL ALL XLS PANELS HAVE BEEN LAYED.

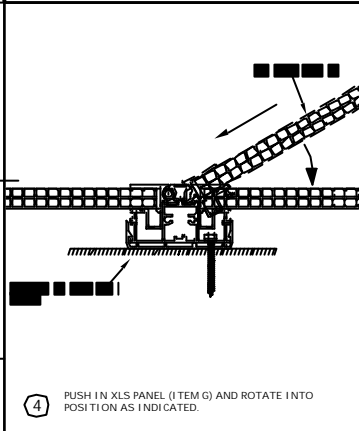

4 PUSH IN XLS PANEL (ITEM G) AND ROTATE INTO POSITION AS INDICATED.

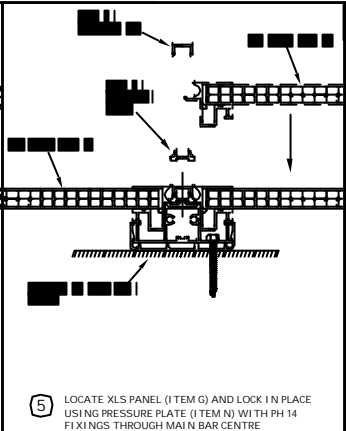

5 LOCATE XLS PANEL (ITEM G) AND LOCK IN PLACE USING PRESSURE PLATE (ITEM N) WITH PH 14 FIXINGS THROUGH MAIN BAR CENTRE

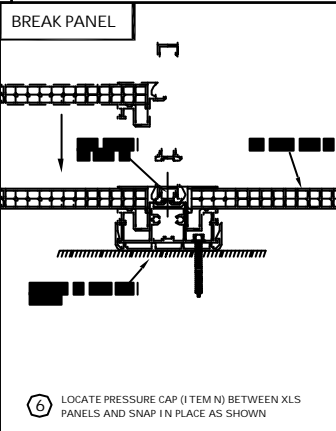

6 LOCATE PRESSURE CAP (ITEM M) BETWEEN XLS PANELS AND SNAP IN PLACE AS SHOWN

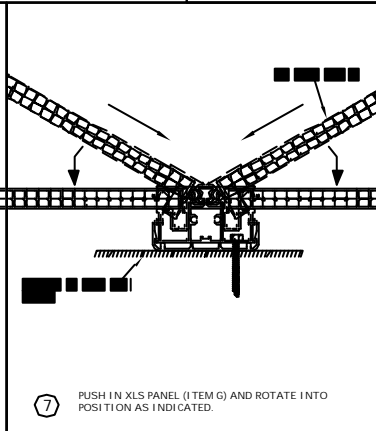

7 PUSH IN XLS PANEL (ITEM G) AND ROTATE INTO POSITION AS INDICATED.

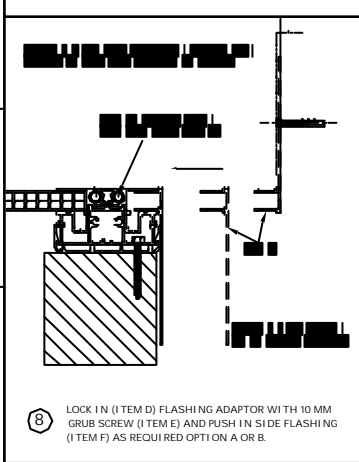

8 LOCK IN (ITEM D) FLASHING ADAPTOR WITH 10MM GRUB SCREW (ITEM E) AND PUSH IN SIDE FLASHING (ITEM F) AS REQUIRED OPTION A OR B.

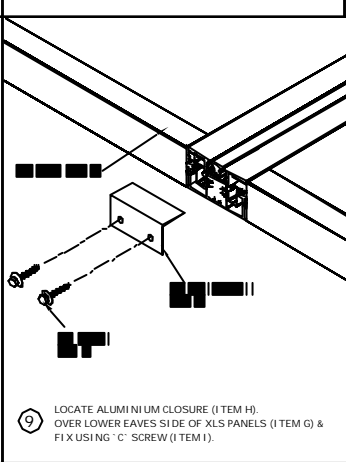

9 LOCATE ALUMINIUM CLOSURE (ITEM H) OVER LOWER EAVES SIDE OF XLS PANELS (ITEM G) & FIX USING 'C' SCREW (ITEM I).

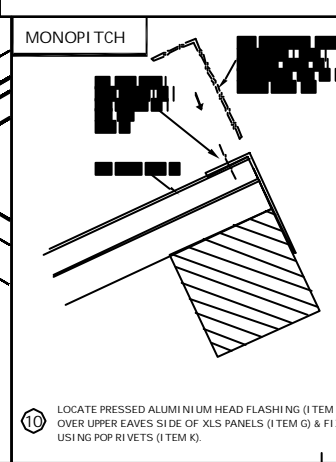

10 LOCATE PRESSED ALUMINIUM HEAD FLASHING (ITEM J) OVER UPPER EAVES SIDE OF XLS PANELS (ITEM G) & FIX USING POP RIVETS (ITEM K).

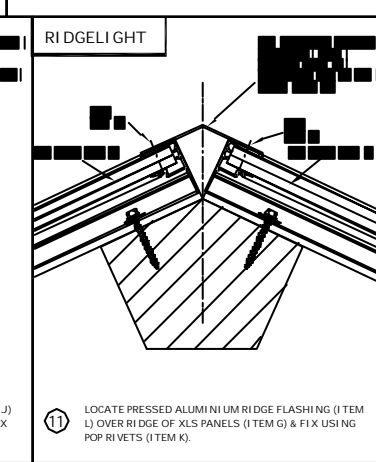

11 LOCATE PRESSED ALUMINIUM RIDGE FLASHING (ITEM L) OVER RIDGE OF XLS PANELS (ITEM G) & FIX USING POP RIVETS (ITEM K).

IMPORTANT NOTES:

Prior to installation / First Fix of the unit, the xls starter panel and all associated panels should be loosefit, without any fixings onto the kerb to ensure the starter panel is square to the kerb.
It is highly likely that should the above not be completed prior to permanent fixing then the unit may run 'Off Line' on the kerb.



XLS FIXING INSTRUCTIONS (BREAKER PANEL).

do	NTS	A
		30